

PROPOSED QUARANTINE STATION EAST OF SANITARY JETTY.
PORT STANLEY.

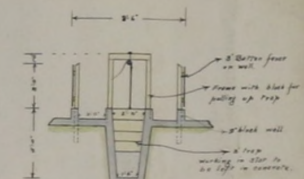

SECTION C.D.

Note: Two doors are to be put in from draining pan each one for dip & one for rain water. Water is to be led in from tank to dip. Doors is to be led to bench for draining dip.

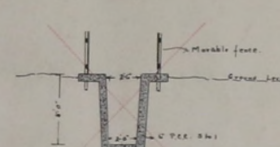
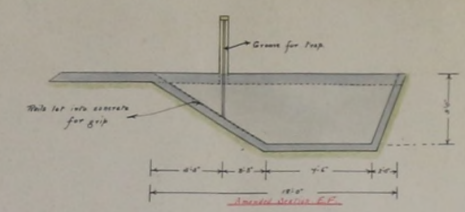
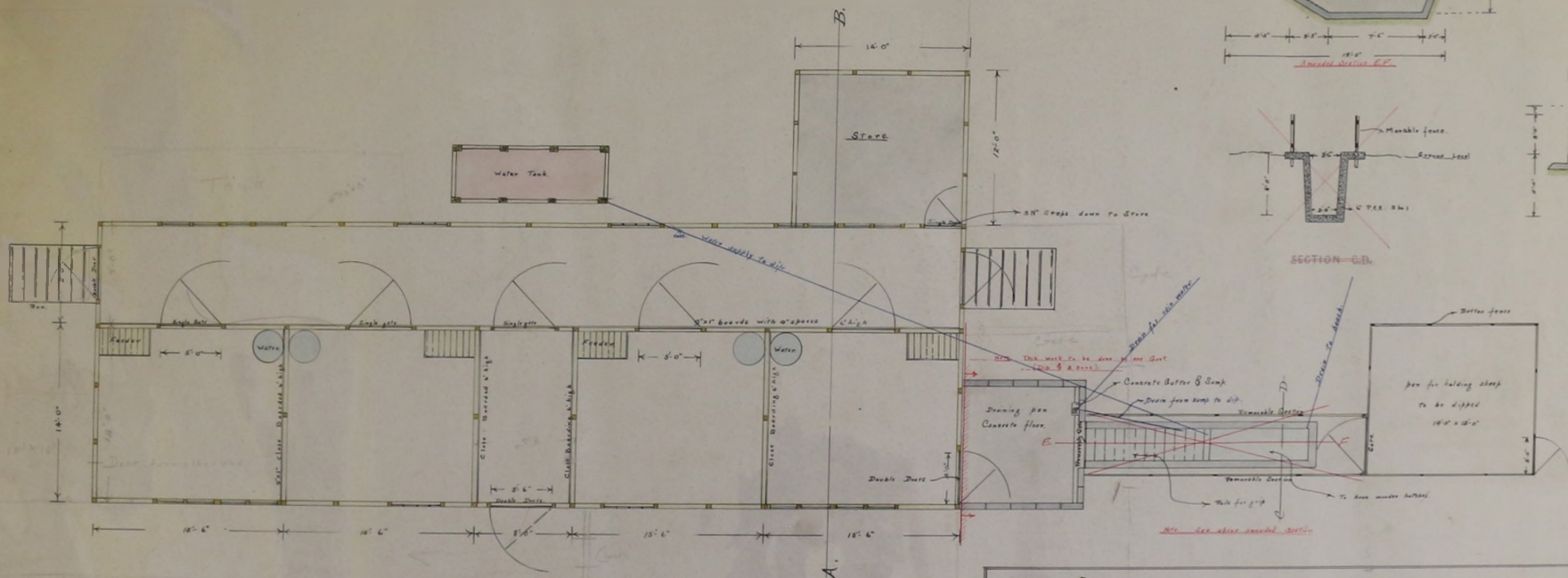
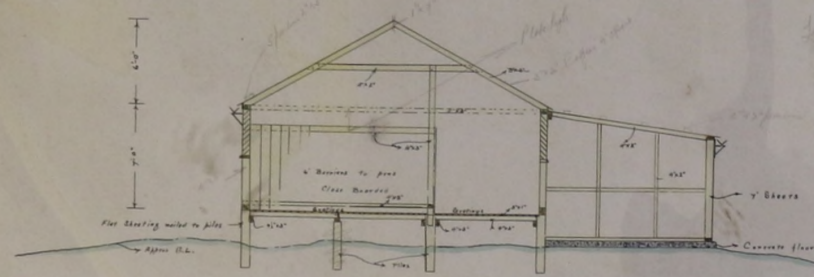

Scale 1/2\"/>

SECTION A.B.

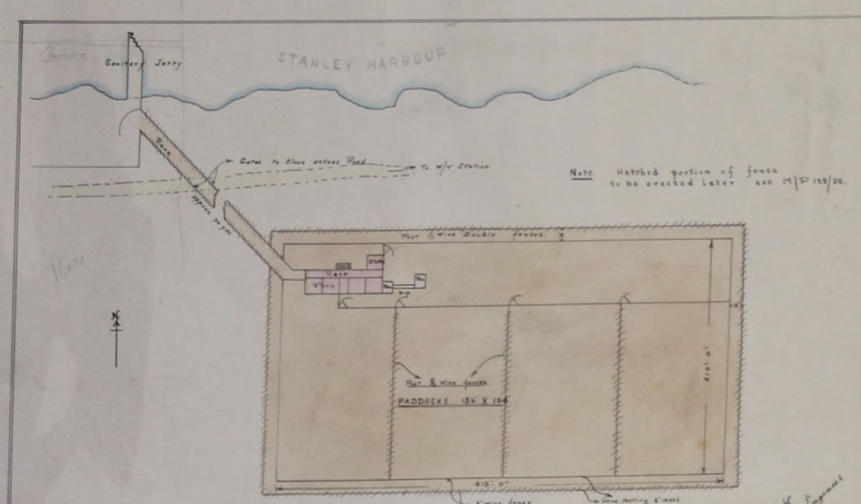

GENERAL LAYOUT. AREA INSIDE PADDOCKS - 2 ACRES.

A. Robert
Sanitary Engineer
21 May 1926

M. P. 56/27 Drawing No. 85.

SECTION 6.

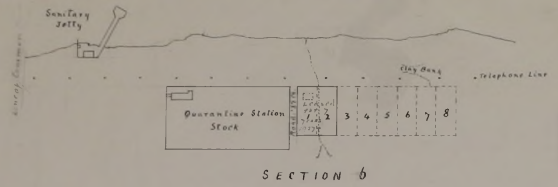

SECTION 6

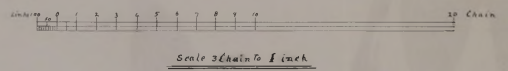

Handwritten signature and title:
 [Signature]
 Electrical Engineer
 21 March 1927

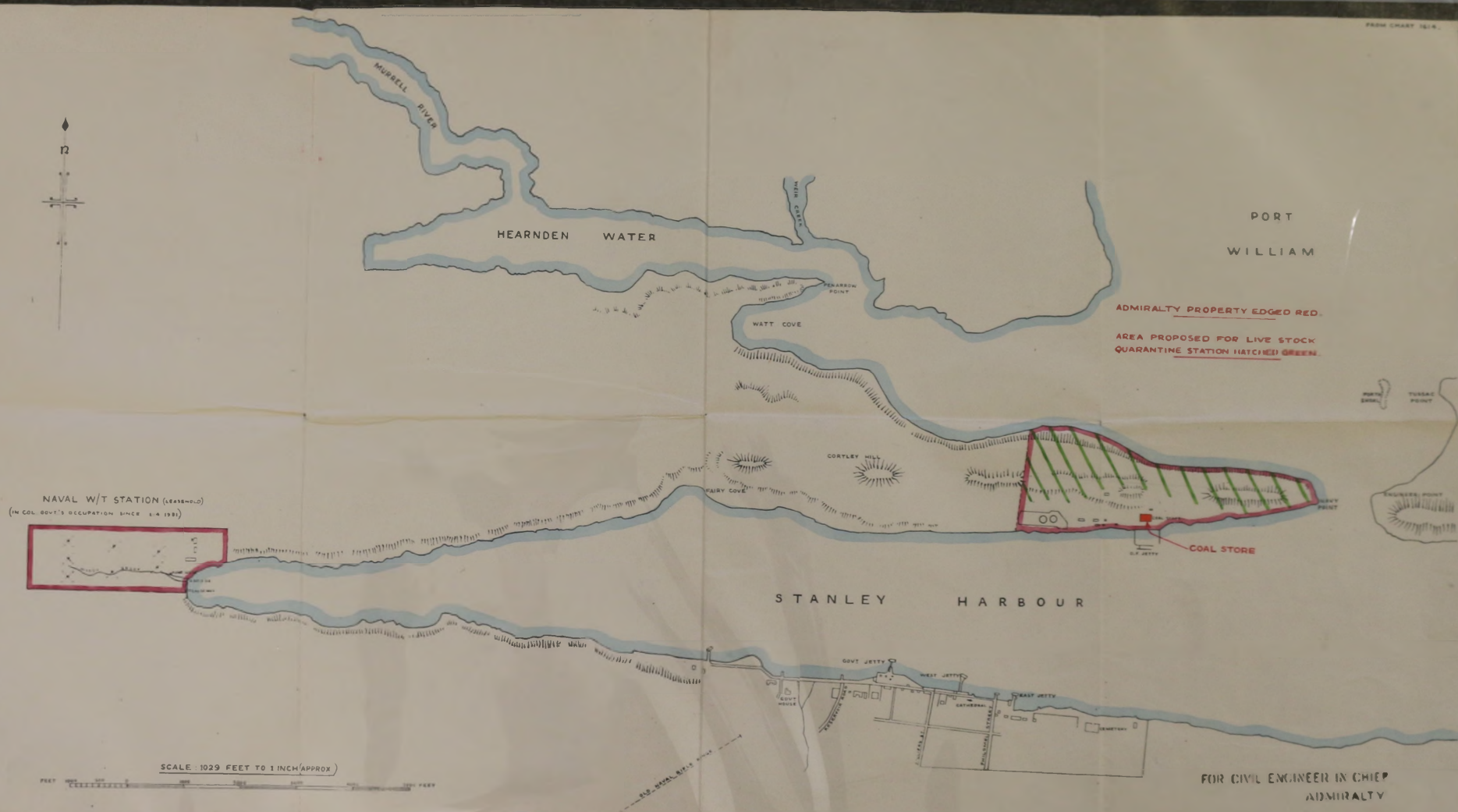
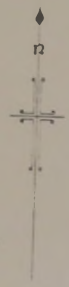

NAVAL W/T STATION (LEASE-HOLD)
(IN COL GOV'T OCCUPATION SINCE 1.4.1931)

ADMIRALTY PROPERTY EDGED RED.
AREA PROPOSED FOR LIVE STOCK
QUARANTINE STATION HATCHED GREEN.



SCALE: 1029 FEET TO 1 INCH (APPROX)

FOR CIVIL ENGINEER IN CHIEF
ADMIRALTY

PROPOSED QUARANTINE STATION NAVY POINT.

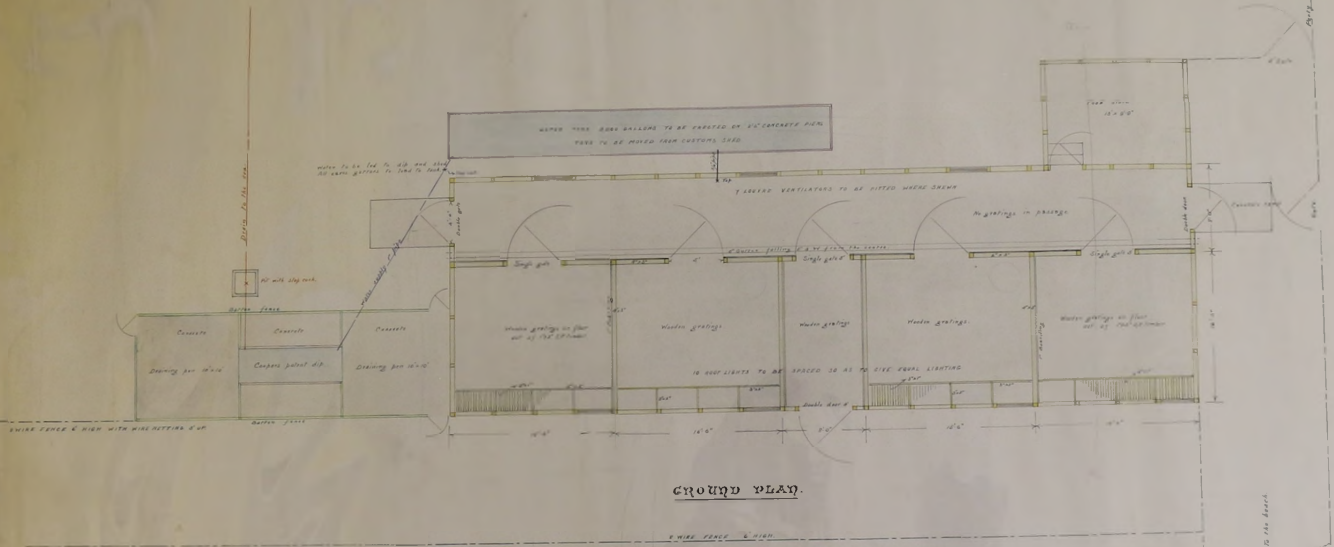

GROUND PLAN.

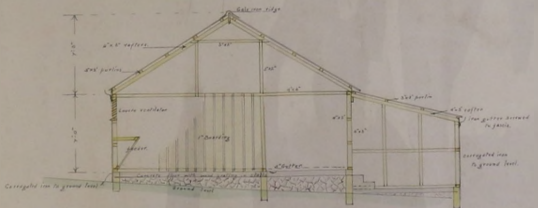

SECTION AA.

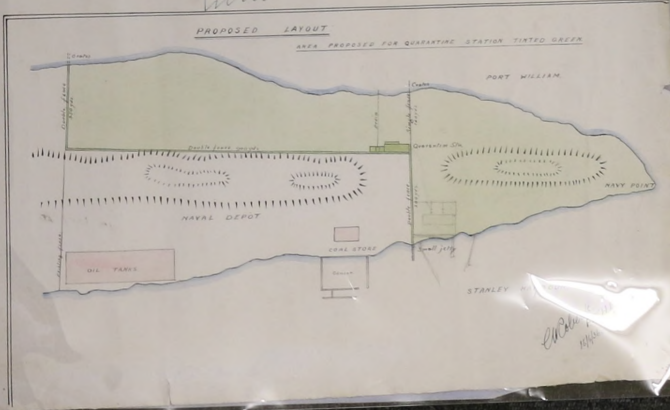

Handwritten signature and date:
E. W. B. 1936

