

SECRETARIAT

(Formerly)

2 2 4 4	2
	2
	4
	4

PLAN OF STANLEY.

CONNECTED FILES.

NUMBER

0946

Topo & cadastral survey in the 1920s

30th August,

62.

Sir,

During the war the Royal Engineers carried out a Topographical Survey of the town of Stanley and produced a very useful 1:2,500 scale plan of the town. Unfortunately only a very few copies now exist and I am wondering if you could produce something similar from the material you have. I believe the photo 26/FI/36/139 covers the area required but in case I have quoted wrongly the plan should commence from the Aircraft Hangar on the west margin extending eastward to 937.000 yards east and southward from the foreshore to 3733.300 yards north.

2. Would you please be good enough to let me know whether it is possible to produce such a plan and if possible give some indication of the cost per 100 copies.

3. I note that on 10th June 1960, your reference 504/11, you promised to produce a one (or two) sheet map of the whole Islands reduced from the complete 1:50,000 series and I should be glad to learn if this is now being contemplated.

I am,

Sir,

Your obedient servant,

(Sgd.) H.L. Bound

for COLONIAL SECRETARY.

The Director,
Directorate of Overseas Surveys,
Kingston Road,
Tolworth,
Surrey,
SURREY.

HLB/LH

Reply at 522
See 528.

See 52.



DIRECTORATE OF OVERSEAS SURVEYS

Kingston Road, Tolworth,

SURBITON, Surrey,

England.

Our reference: 504/11

Your reference: 0946/III

5th October, 1962.

Dear Manders,

Your office letter of 30th August.

1. The area you describe in your first paragraph is covered by two sheets at 1:2,500, Port Stanley & Falkland Camp. The War Office have small stocks of copies and we are asking them if they can spare some for you. Your second paragraph leads me to think that you can meet their charges if they insist on payment - though we hope that our offer to revise the sheets may influence them to make you a free issue.
2. Examination of the November 1956 air photos shows little change on the Port Stanley sheet (though we understand that there have been some changes since 1956) and considerable change on the Falkland Camp sheet. You may, therefore, prefer not to have more copies of the Falkland Camp sheet but to wait for a revised edition.
3. We can undertake revision of both sheets, doing the best we can with the 1956 air photography which is, of course, at a very much smaller scale. Since this still leaves the sheets six years out of date I suggest that completion of the revision be done on the spot either by some local individual, e.g. a member of the P.W.D., or by returning B.A.S. surveyors. We could get the revised sheets to Stanley by say February 1963 which would give time for the necessary field work. On receipt of the revised material back here we would prepare and print new editions of both sheets and send you stocks free of charge.
4. We have not yet made a start on a one (or two) sheet map of the Falkland Islands but still hope to do so in the not too distant future. All 29 sheets of the 1:50,000 map have been printed and stocks despatched to you.

yours sincerely

W.D.C. Wiggins

W.D.C. Wiggins
Deputy Director (B)

The Colonial Secretary,
Stanley,
Falkland Islands.

See 504/11
Reply at 3
See 508.6



ON HER MAJESTY'S SERVICE



The Colonial Secretary,

Stanley,

Falkland Islands.

← First fold here →

← Second fold here →

Sender's name and address:

DIRECTORATE OF OVERSEAS SURVEYS.

KINGSTON ROAD, TOLWORTH,

SURBITON, SURREY.

AN AIR LETTER SHOULD NOT CONTAIN ANY
ENCLOSURE; IF IT DOES IT WILL BE SURCHARGED
OR SENT BY ORDINARY MAIL

→ To open cut here →

Telephone: Derwent 8661.



Our Refce.

Your Refce.

504/11

0946/III
13 NOV 1962
BUT

~~528~~ 6
DIRECTORATE OF OVERSEAS SURVEYS,
KINGSTON ROAD,
TOLWORTH, SURBITON,
SURREY.

30th October, 1962.

Dear Sir,

1:2,500 Map of Stanley, Falkland Islands

~~501~~
~~502~~ Please refer to your letter No. 0946/III dated
30th August and to Mr. Wiggins reply of 5th October.

~~524~~ 3
It is regretted that the War Office find that
they cannot spare any copies of the existing 1:2500
sheets for your use. We hope we will hear from
shortly whether our proposals for producing a revised
edition are acceptable.

Yours faithfully,

C. I. M. O'Brien

C. I. M. O'Brien

The Colonial Secretary,
Stanley,
Falkland Islands.

~~7~~
seen
ackn on 5/27
8
6/4/62.
Kiv ~~507~~ 5

~~1~~ 3

3rd November, 1962.

Dear Wiggins,

~~ST~~ 2 Thank you very much for your letter of 5th October, 1962. We gratefully accept your offer to revise the sheets and send them out in February and I will try to make arrangements and have them brought up to date as suggested.

Yours sincerely,

(R.H.D. Manders)

Reply at ~~526~~ 17

W. D. C. Wiggins, Esq.,
Deputy Director,
Directorate of Overseas Surveys,
Kingston Road,
Tolworth,
Surrey.
SURREY.

RDM/TE

9th November, 1962.

From: The Colonial Secretary,

To: Officer-in-Charge,

British Antarctic Office,

STANLEY.

Map Sheets - Stanley and ex Army Camp

Arrangements have been made with the Directorate of Overseas Surveys for the two map sheets of Stanley and the ex Army Camp area to be brought up to date with the assistance of photographs from the 1956 aerial survey. As there will be some changes since 1956 the Directorate of Overseas has suggested that one of the returning BAS surveyors could undertake an on the spot revision. I would enquire therefore if you could kindly arrange for a BAS surveyor to undertake this revision.

2. The two sheets should arrive here in February 1963.

(Sgd.) M.L. Bound

for COLONIAL SECRETARY.

No. 413/80B

It is requested that any reference to this memorandum the above number and date should be quoted.



12th November, 19 62

Hon. Colonial Secretary,

Port Stanley.

O.I.C. British Antarctic Survey,

Stanley, Falkland Islands.

SUBJECT :-

Map Sheets - Stanley and ex Army Camp

I have discussed this with H.E., and it has been agreed that it should be possible to bring a Surveyor out of Hope Bay early in order to undertake the revision of the maps. I have spoken to the Surveyor in question and he seems quite keen to assist. May I suggest that all necessary aerial survey photographs be found and made available for him at your earliest convenience in order to prevent any delay.

It is wondered if there are any outstanding Colony survey requirements for which the opportunity could be taken to clear whilst the Surveyor is in the Colony. If there are, it might be possible to bring him out of Hope Bay during January. This would give two months availability.

E. PLH

529 S.
I wonder when Ben could find the
things to be home photos re A.O.

Could Ben see if she would find it
he knows where the children station.

x | ACS (can we think of any names we
want but we have small GPh & SPL

or
12/1/62.

11-19-62

~~520~~ 8

A.C.S. 5

f. 527 noted thank you. I will arrange with A.O. on his return from Camp. If S.P.W. or S.P.E. suggest further surveys we could look for the necessary photographs at the same time, pl.

§

20. 11. 63.

pm

KIV - x/ on ~~527~~ 5

~~521~~ 9

S/C

as above pl.

File can then go to Stuart SPE for comment on para 2 of 527⁴.

26. 11. 63

Circular No.

762/62

Circular Note

Falkland Islands

535

10

Transmitted with the compliments of
the Secretary of State for the Colonies, for
information and distribution.

Colonial Office

(2/62) (E4792) Wt 13472-8387 2m 5/62 V.B. Gp 791

26 NOV 1962

536.11 : : 521527

Directorate of Overseas
(Geodetic & Topographical)
Surveys.

Annual Report for the year
ended 31st March, 1962,

Telephone: Derwent 8661.

DIRECTORATE OF OVERSEAS SURVEYS,
KINGSTON ROAD,
TOLWORTH, SURBITON,
SURREY.



11th December 1962

Our Refce.

Your Refce.

504/11

Dear Sir,

1:2500 Plan of Stanley

524 B Please refer to your letter 0946/III dated 3rd November.

In Classified Room 839543 We are forwarding to you two copies, one on bromide paper and one on permatrace of the 1:2500 sheets "Port Stanley" and "Falkland Camp" graphically revised for the air photographs taken in 1956. We would be grateful if you could arrange for these to be checked, and if necessary revised before we complete fairdrawing.

We would like these corrections to be supplied to us in the following way:

All additional surveyed detail should be plotted on the permatrace copies.

All deletions, place names and new unsurveyed detail can be annotated on the bromide prints.

If possible we would like the following classes of information shown in distinctive colours:

- (1) All features which should be deleted
- (2) All additions including place names and descriptive names
- (3) All other alterations. In such cases the feature effected can be circles on the bromide and a line drawn out to the margin where an explanatory note can be written (e.g. "This line should be shown as a fence")

The colour code commonly used is (1); Green, (2); Red and (3); Purple.

I have listed below some points of which the field checkers may require guidance during their work.

(a) Place names. (Including descriptive names). All new or corrected names should be marked on the bromide in the position in which they should appear. It would also help us if they could appear in a typed list. (Spellings in the latter will be taken as authoritative). Any name which is left untouched on the bromide will be assumed to be approved by you.

(b) Buildings: We have not been able to show the materials for which new buildings have been constructed. If the classification shown on the original maps is still needed field checkers should be asked to record the necessary information, both for buildings added by us and for any others which they may survey. The existing maps show public buildings in black. If any public buildings are now private, or vice versa, please draw a line around the buildings concerned and make a note on the margin of the bromide.

(c) All unwanted detail, e.g. buildings demolished since 1956, should be struck out with green crosses.

(d) New

(d) New buildings and roads. These should be surveyed and plotted on the permatrace sheets.

(e) Detail not visible on the photographs. Plot as (d). Owing to the very small scale of the air photographs it is possible that we may have omitted fences enclosing new houses such as those on the East of the "Falkland Camp" sheet.

(f) Other minor features. It may be that you will wish to have such things as telephone poles, electric power poles, manholes etc. shown. If you can supply these, we will include them on the map.

There are one or two other points on which we would like your views:

Titles "Port Stanley" should presumably be altered to plain "Stanley". "Falkland Camp" now seems to be a misnomer. Perhaps the sheets could better be titled "Stanley sheets 1 & 2" or "East and West".

Stock and Sales How many copies will you need of each sheet? Will you be putting them on sale locally?

16 + 24
S. 16 + 24
As it may be necessary to run some short traverses to fix new detail I am enclosing a list of Stanley local triangulation stations giving co-ordinates both on the Universal Transverse Mercator Grid (in metres) and on the "US War Department Polyconic Projection (Southern Hemisphere) Bank V (South), Zone H" grid (in yards). The latter grid is obsolete but we have included it as it is shown around the edge of the existing plan. We would suggest that any new surveys be carried out on the U.T.M. grid. With these I am including copies of descriptions of stations in Stanley.

Yours sincerely,

C. I. M. O'Brien

C. I. M. O'Brien
Records Officer

The Colonial Secretary,
Stanley,
Falkland Islands.

Results of Military Survey of 1943 Transferred from

US War Dept Polyconic Projection Band V (South) Zone H (YARDS) to UTM Zone 21 (Meters)
see note at end of Sheet 2 International Spheroid

Common Points

Military Survey 1943

Sapper Hill

Mt Misery

e
932 797.6
925 933.7
Δe + 6 863.9
n
3 733 038.8
3 745 293.5
Δn - 12 254.7

DOS Survey 1958

P20 Sapper Hill

P22 Round Mt

E
438 572.73
432 298.42
ΔE + 6 274.31
N
4 271 433.66
4 282 635.24
ΔN - 11 201.58

$$P \cdot \frac{\Delta E \Delta c + \Delta N \Delta n}{\Delta e^2 + \Delta n^2} = +0.914 \ 07325$$

$$R = E_A - P e_A - \Phi n_A = -4.14 \ 010 \ 9$$

$$E_B - P e_B - \Phi n_B = -4.14 \ 010 \ 9$$

$$\Phi \cdot \frac{\Delta E \Delta n - \Delta N \Delta e}{\Delta e^2 + \Delta n^2} = -0.000 \ 01653$$

$$S \cdot N_A + \Phi e_A - P n_A = +859 \ 147.3$$

$$N_B + \Phi e_B - P n_B = +859 \ 147.3$$

$$E = R + P e + \Phi n$$

$$N = S - \Phi e + P n$$

$$(E - 400,000) = +8593.3 + 0.914 \ 073 (e - 900,000) - 0.000 \ 017 (n - 3,700,000)$$

$$E = -4.14 \ 010 \ 9 + 0.914 \ 07325 \cdot e - 0.000 \ 01653 \cdot n$$

$$N = +859 \ 147.3 + 0.000 \ 01653 \cdot e + 0.914 \ 07325 \cdot n$$

$$(N - 4,200,000) = +41233.2 + 0.000 \ 017 (e - 900,000) + 0.914 \ 073 (n - 3,700,000)$$

Polyconic

UTM

Name	Mark	H ft	Polyconic		UTM	
			e	n	E	N
Mt 1520 (Int)	Cairn	1552.5	914 423.3	3 733 242.5	421 777.3	4 271 619.5
Needle (Int)	Cairn	1349.5	914 687.5	3 732 251.3	422 018.8	4 270 713.5
Mt 1340	Block	1368.2	914 584.8	3 731 458.8	421 924.9	4 269 989.1
Estancia (Int)	Cairn	1001.2	914 974.2	3 740 588.7	422 280.7	4 278 334.5
Lincon	Block	244.4	915 815.2	3 726 007.9	423 049.7	4 265 006.6
Kingvic (Int)	Cairn	1190.6	916 831.5	3 732 049.9	423 978.6	4 270 529.4
Mt 1240	Block	1174.2	917 009.1	3 731 932.2	424 140.9	4 270 421.9
Mt Kent (Int)	Cairn	1385.7	917 099.7	3 736 569.4	424 223.6	4 274 660.6
Mt Kent	Block	1376.9	917 107.1	3 736 571.5	424 230.4	4 274 662.5
Mt Vernet	Cairn	1281.5	917 208.4	3 742 473.6	424 322.9	4 280 057.4
McGills	Block	33.0	917 685.3	3 749 344.8	424 758.7	4 286 338.3
North Rushover (Int)	Cairn	1046.2	917 932.7	3 732 116.9	424 985.1	4 270 530.7
South Rushover (Int)	Cairn	1024.4	918 239.1	3 732 026.3	425 265.2	4 270 507.9
Long Island West	Block	72.1	918 319.8	3 751 176.8	425 338.7	4 288 012.8
Bald Pt (Int)	Block	58.3	919 458.8	3 724 797.7	426 380.2	4 269 900.4
North Basin	Block	130.3	919 618.9	3 727 238.3	426 526.5	4 266 131.3
Hill 15 (Int) Black Cairn		968.5	919 633.2	3 744 472.1	426 557.6	4 281 884.3
East Bluff (Int)	Cairn	512.1	919 933.8	3 736 185.3	426 814.2	4 274 309.5
Wall Mt	Block	897.9	920 952.7	3 732 307.6	427 745.6	4 270 765.1
Long Island East	Block	34.2	921 217.2	3 750 266.2	427 987.1	4 287 180.5
Two Sisters SW (Int)	Cairn	1043.4	922 721.2	3 734 598.5	429 362.1	4 272 859.1
Two Sisters NE (Int)	Block	992.0	923 311.3	3 735 097.7	429 901.5	4 273 315.5
Two Sisters NE	Block	988.5	923 335.1	3 735 100.1	429 923.3	4 273 317.7
Rabbit Rocks	Block	197.9	923 562.0	3 727 075.7	430 130.8	4 265 982.8
Hill 14 (Int) Black Cairn		554.5	923 802.0	3 745 524.6	430 349.9	4 282 846.4
Mt Harriet (Int)	Block	944.7	923 833.9	3 732 475.5	430 379.3	4 270 918.6
Mt Harriet	Block	928.3	923 856.5	3 732 476.3	430 399.9	4 270 919.3
Saddleback (West) Black Cairn		555.5	924 428.3	3 741 892.9	430 922.4	4 279 526.8
Cannon Rocks	Block	171.8	925 716.8	3 727 914.1	432 100.4	4 266 749.2
Mt Misery	Black Cairn	514.6	925 933.7	3 745 293.5	432 298.4	4 282 635.2
Mt McLaughlin (Int)	Block	624.6	925 940.6	3 737 088.6	432 304.9	4 275 135.3
Mt McLaughlin	Block	612.4	925 953.5	3 737 064.7	432 316.6	4 275 113.5
Saddleback East Black Cairn		450.6	926 231.2	3 741 883.9	432 570.4	4 279 518.6
Turnballedown Mt	Black Cairn	824.3	927 364.5	3 734 013.3	433 608.3	4 272 868.2
Trig Rock	Block	243.9	928 741.2	3 745 737.7	434 864.7	4 283 041.3
Mt Williams	Block	796.3	928 825.9	3 732 842.6	434 942.3	4 271 259.2
Dead Gun Pt (Int)	Cairn	102.7	928 908.4	3 728 414.1	435 017.8	4 267 206.2
Murrell River	Block	205.3	929 545.1	3 740 274.1	435 599.6	4 278 047.2

M 36
= P22

M 35

Name	Mark	H ft	Plyconic		UTM			
			n	E	N			
North Wt Mast	Top	344.7	930 495.3	3735 331.1	436 468.2	4 273 528.9		
South Wt Mast	Top	336.4	930 502.3	3735 247.9	436 474.6	4 273 499.2		
Long Island Ridge	Block	501.8	931 168.2	3742 627.4	437 083.2	4 280 198.3		
Penguin	Block	79.0	931 679.2	3728 311.5	437 550.5	4 267 112.5	= M34	
Camber	Cartridge		932 117.7	3735 567.5	437 951.2	4 273 745.0		
Sea View	Block	227.8	932 182.8	3745 222.3	438 010.6	4 282 570.2		
Sapper Hill	Block	452.9	932 797.6	3733 038.8	438 572.7	4 271 433.7	= P20	
West Base Terminal	Cartridge	48.7	932 856.1	3734 529.7	438 626.2	4 272 796.4		
Point D	Block	153.7	933 256.4	3735 764.4	438 932.1	4 273 925.0		
East Base Terminal	Cartridge	51.2	933 845.5	3734 505.8	439 530.6	4 272 774.6		
Seal Point	Block	57.2	934 118.9	3728 520.1	439 780.6	4 267 503.2	= M33	
12 O'Clock Mt (Aux)	Block	845.9	934 172.6	3742 637.3	439 829.4	4 280 267.4		
12 O'Clock Mt	Block	827.0	934 176.3	3742 540.1	439 832.8	4 280 118.5		
Cortley Hill	Block	159.6	934 778.9	3735 786.9	440 383.7	4 273 945.6		
Buzzards	Block	183.7	935 013.4	3744 894.7	440 597.9	4 282 270.8		
Lovely Ridge	Block	204.5	936 713.7	3738 562.9	442 152.4	4 276 483.1		
Mt Low	Block	868.9	937 278.4	3742 231.6	442 668.4	4 279 836.6	= P25	
Beacon B (Int)	-	109.0	937 437.7	3733 851.1	442 814.1	4 272 176.2	diff from D.O.S	
Sea Lion	Block	158.2	937 720.0	3744 159.5	443 072.0	4 281 598.8	E - 0.2 m	
Eliza Cove	Block	30.4	938 661.0	3731 467.0	443 932.3	4 269 997.0	N - 0.5 m	
Peat Ridge	Block	157.7	940 238.2	3743 413.1	445 373.8	4 280 916.6	H - 2.5 ft	
Cochan Is. (Int)	Block	101.0	940 371.7	3745 185.5	445 495.8	4 282 536.7	= M37	
Canopus	Block	110.4	940 910.2	3734 891.0	445 988.2	4 273 126.8		
Treburns	Block	135.0	941 529.1	3740 962.3	446 553.8	4 278 676.4		
Kidney Is (Int) Boulder		32.0	943 671.1	3742 645.2	448 511.7	4 280 214.8		
Mungeary Lt Hse	Centre	65.0.8	945 031.2	3740 199.8	449 755.0	4 277 979.5	= M38	
Cape Rumbold Lt Hse	Centre	62.51.4	945 828.6	3735 855.6	450 484.0	4 274 008.6		
Stanley: -								
Monument	Centre		934 106.3	3734 679.8	439 768.9	4 272 933.6		
West Fence Cur	Post		934 183.7	3733 609.5	439 839.7	4 271 955.3		
Govt House F.S	Flagstaff		934 375.9	3734 514.6	440 015.4	4 272 782.6		
Brandon Road	Δ in Kerb		934 554.6	3734 292.0	440 178.7	4 272 579.2		
Russ Road Lamppost			934 767.3	3734 589.5	440 373.2	4 272 851.1		
Town Hall (Gd Stn 3)	Δ in Kerb		934 942.9	3734 559.9	440 533.7	4 272 824.1		
Town Hall Spire	Vane		934 980.8	3734 576.3	440 568.3	4 272 839.1		
Callaghan Road	Block		935 088.1	3734 073.1	440 666.4	4 272 379.1		
Cathedral Spire	Vane		935 378.8	3734 480.2	440 932.1	4 272 751.2		
Cathedral (Gd Stn 1)	Δ in Gutter		935 529.1	3734 491.7	441 069.5	4 272 761.7		
Snake Hill	Block		936 130.9	3734 217.0	441 619.6	4 272 510.6		
Lookout Rocks	Δ in Rock		936 161.1	3733 765.1	441 647.2	4 272 097.6		
East Fence Junc	Post		936 513.8	3733 325.8	441 969.6	4 271 696.0		
East Point	Block		936 783.3	3734 323.2	442 215.9	4 272 607.7		
BENCH MARKS Stanley: -								
Monument		23.8	934 068	3734 675	439 734	4 272 929		
Steps		10.0	934 210	3734 610	439 864	4 272 870		
Valley Gate	Arrow in Rock	130.0	934 251.2	3734 245.5	439 901.4	4 272 536.7		
Culvert		64.8	934 488	3734 327	440 118	4 272 611		
Garage		41.9	934 537	3734 423	440 163	4 272 699		
Town Hall	datum	22.2	934 940	3734 585	440 531	4 272 847		
'Meteor' Office		11.2	935 450	3734 492	440 997	4 272 762		

Projection: Ordinary Plyconic Central Meridian 51° 00' West Origin: Equator False E 1,000,000 yds East
 Spheroid: Clarke 1866 Units: Yards (Clarke's relation of metre/yard) False N 10,000,000 yds North

Note All Northings (m) listed above are ~~raw~~ projection coords corrected to give conformality
 ie $n = \text{Conformal Northings} = \text{projection Northings} + C$ where $C = \frac{(E^2 - 10)^2}{(3,720,000 - N)}$ yds
 9746.2

20

A. West Base Terminal.

Found in '64 R.I.

.303 cartridge case set in concrete block.

Flush with ground.

Situated 20 yards approx. beyond the fence at the west end of the racecourse.

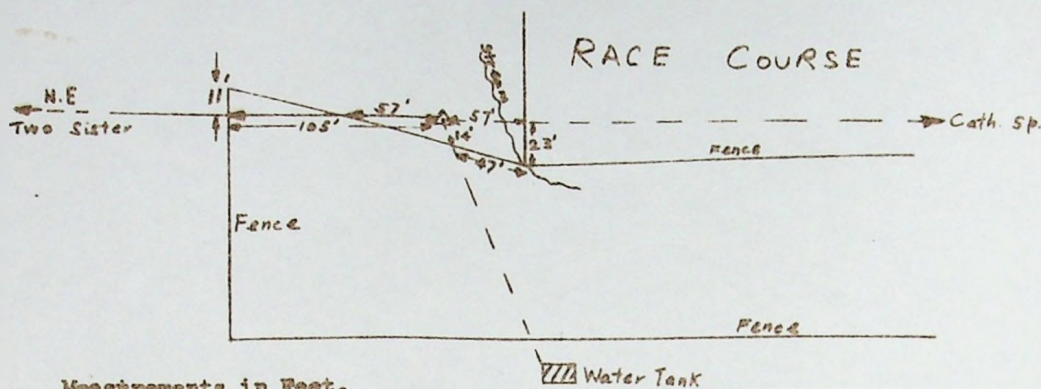

B. East Base Terminal.

Found in '64 R.I.

.303 cartridge case set in concrete block.

Flush with ground.

Situated at the east end of the racecourse and 3 yards north of the northern boundary fence.

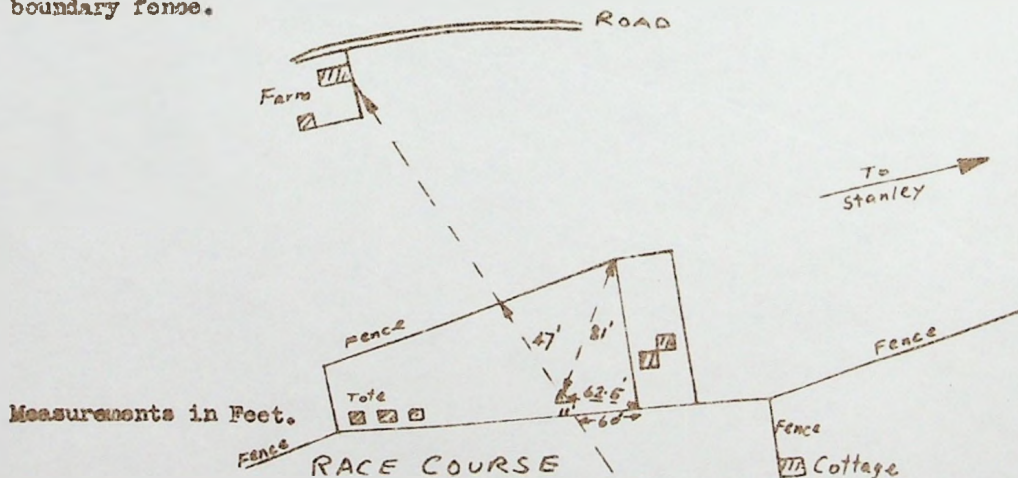

C. Monument.

Found in '64 R.I.

Centre (Mainmast of model ship).

This station is the memorial to commemorate the Battle of the Falkland Islands and is situated in Ross Road West approx. 270 yards north west of Government Ho.

D. West Fence Corner.

Still in existence

but facing over.

Substantial wooden post at fence corner.

At the extreme west end of the most southerly fence running parallel with the town, approx. $\frac{1}{2}$ mile south of Government House.

510
21

E. Valley Gate Benchmark.

Not found (fences now different)

Arrow out on flat rock.

Not found in '61

Situated on a flat rock approx. 27 feet N. of Sapper Hill Road.

Cath Sp.

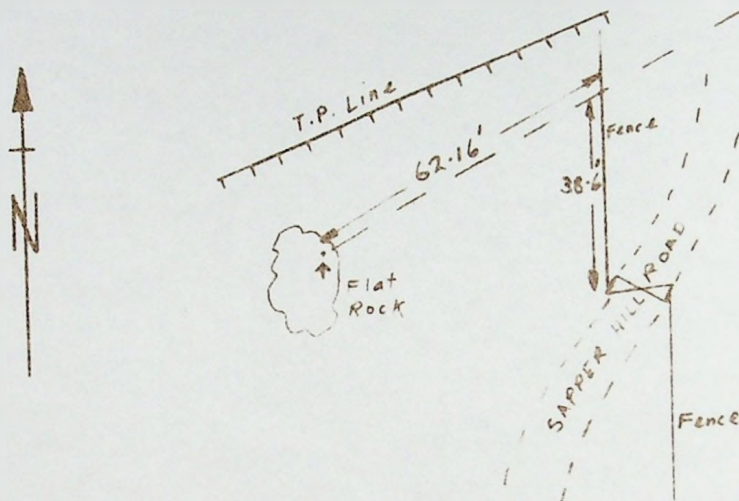

F. Government House Flagstaff.

Now Flagstaff moved since '62
old one left behind. R.V.

On the north side of the fence bounding the drive from the house to the road

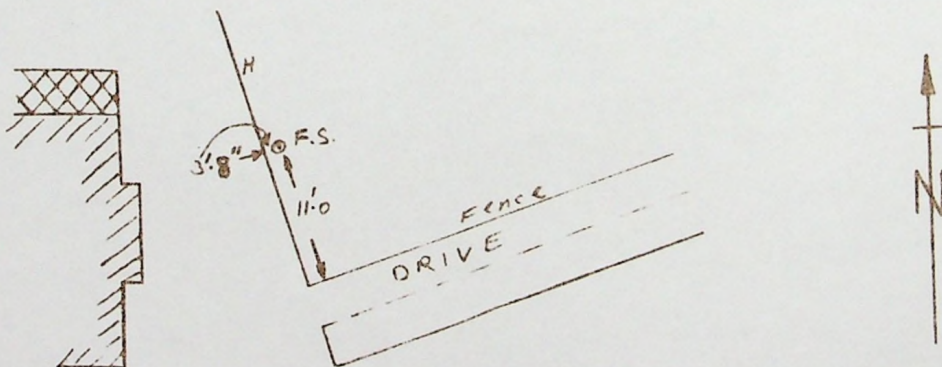

G. Brandon Road.

Triangle cut on kerb.

On south side of Brandon Road. Measurements in Feet and Inches.

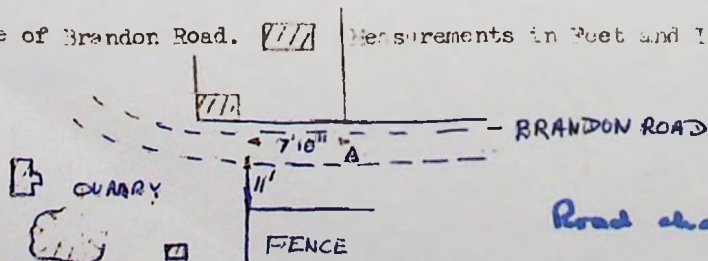

Road changed since '62
R.V.

H. Ross Road Lamp Post.

There is 'no' R.S.

22

At western end of Ross Road on north side of road, on straight of fence.

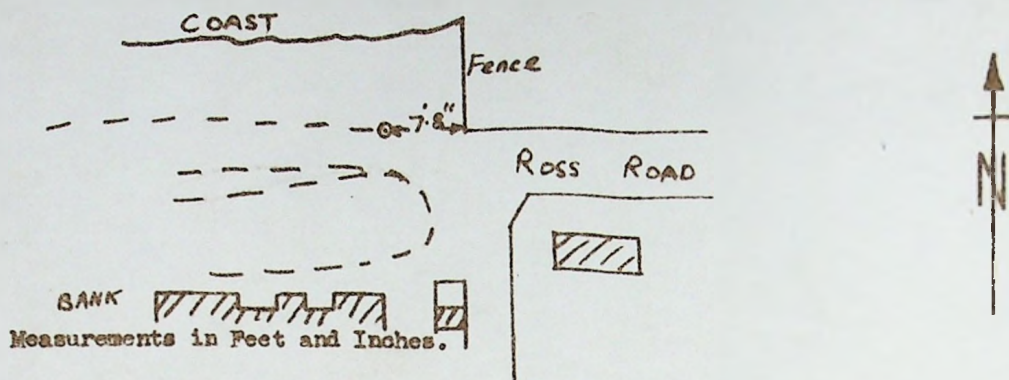

J. Ground Station 3 (Town Hall).

old lines was 'no'

Triangle cut in kerb.

Situated on the south side of Ross Road at the junction of Ross Road and Barrack Street.

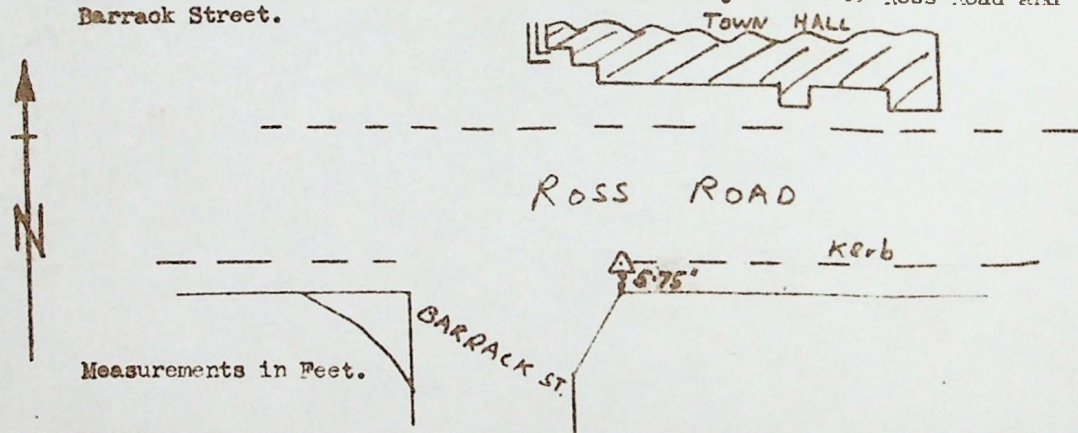

K. Town Hall Spire.

(old Town Hall burnt down 1944)

Vane on spire at east end of Town Hall.

L. Callaghan Road.

.303 cartridge case in concrete block.

Projects 6"

Situated at the junction of Callaghan Road and Villiers Street and is on the line of the west fence of Villiers St.

Measurements in Feet.

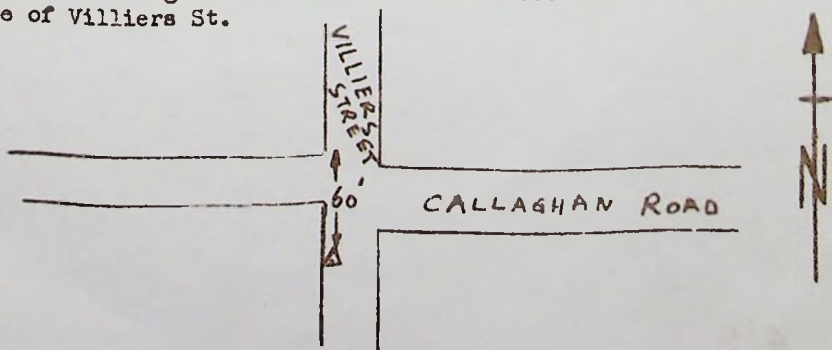

M. Stanley Cathedral Spire.

Central Vane on spire.

N. Ground Station 1 (Cathedral).

Triangle out in gutter.

On north side of Ross Road.

STANLEY HARBOUR

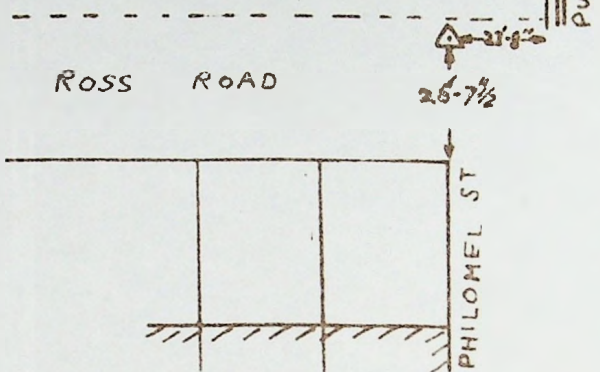

Measurements in Feet.

O. Snake Hill.

(now found)

.303 cartridge case in concrete block.

Projects 6" above surface.

Situated on the north side of Snake Hill Road about 30 yards east of

Memorial Cottage.

Memorial Cottage

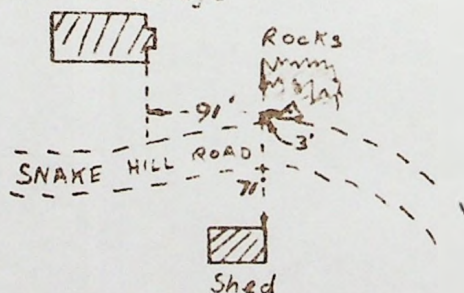

Measurements in Feet.

P. Lookout Rocks.

Iron boltstave set in cement.

Projects 1" above surface.

The Lookout Rocks consist of two large masses of rock on the high ground east of Stanley. The station (a Hutchison survey mark) is on the western end of the western mass of rock, and is approx 300 yards east of a red-roofed house.

Red Roofed Ho.

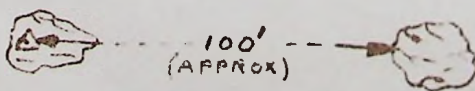

Q. East Fence Junction.

Substantial wooden post.

Situated at east end of most southerly fence running parallel with the town and approx. 1100 yards south east from cemetery.

R. East Point.

Found One foot E of fence AB.

$1\frac{1}{2}$ " iron pipe in concrete block.

Projects 6" above surface.

Situated at the extreme east end of the town approx. 90 yards from end of coast road

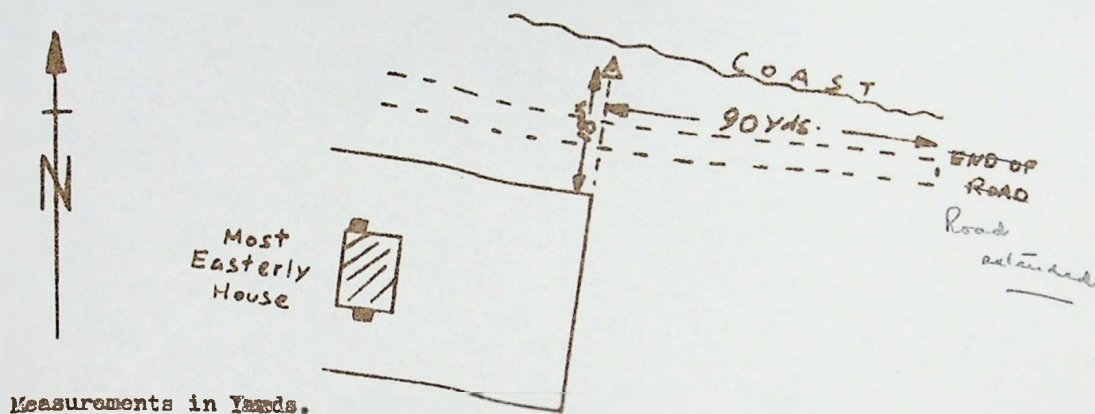

Ray.

I.C.W.

48

11th December 1962

504/11

Dear Sir,

1:2500 Plan of Stanley (45)

Please refer to your letter 0946/III dated 3rd November.

We are forwarding to you two copies, one on bromide paper and one on permatrace of the 1:2500 sheets "Port Stanley" and "Falkland Camp" graphically revised for the air photographs taken in 1956. We would be grateful if you could arrange for these to be checked, and if necessary revised before we complete fairdrawing.

We would like these corrections to be supplied to us in the following way:

All additional surveyed detail should be plotted on the permatrace copies.

All deletions, place names and new unsurveyed detail can be annotated on the bromide prints.

If possible we would like the following classes of information shown in distinctive colours:

- (1) All features which should be deleted
- (2) All additions including place names and descriptive names
- (3) All other alterations. In such cases the feature effected can be circled on the bromide and a line drawn out to the margin where an explanatory note can be written (e.g. "This line should be shown as a fence")

N.B. A colour other than red should be used so that amendments are readily visible

The colour code commonly used is (1): Green, (2): Red and (3): Purple.

I have listed below some points of which the field checkers may require guidance during their work.

(a) Place names. (Including descriptive names). All new or corrected names should be marked on the bromide in the position in which they should appear. It would also help us if they could appear in a typed list. (Spellings in the latter will be taken as authoritative). Any name which is left untouched on the bromide will be assumed to be approved by you.

(b) Buildings: We have not been able to show the materials for which new buildings have been constructed. If the classification shown on the original maps is still needed field checkers should be asked to record the necessary information, both for buildings added by us and for any others which they may survey. The existing maps show public buildings in black. If any public buildings are now private, or vice versa, please draw a line around the buildings concerned and make a note on the margin of the bromide.

(c) All unwanted detail, e.g. buildings demolished since 1956, should be struck out with green crosses.

(d) New

(d) New buildings and roads. These should be surveyed and plotted on the permatrace sheets.

(e) Detail not visible on the photographs. Plot as (d). Owing to the very small scale of the air photographs it is possible that we may have omitted fences enclosing new houses such as those on the East of the "Falkland Camp" sheet.

(f) Other minor features. It may be that you will wish to have such things as telephone poles, electric power poles, manholes etc. shown. If you can supply these, we will include them on the map.

There are one or two other points on which we would like your views:

Titles "Port Stanley" should presumably be altered to plain "Stanley". "Falkland Camp" now seems to be a misnomer. Perhaps the sheets could better be titled "Stanley sheets 1 & 2" or "East and West".

Stock and Sales How many copies will you need of each sheet? Will you be putting them on sale locally?

As it may be necessary to run some short traverses to fix new detail
/. I am enclosing a list of Stanley local triangulation stations giving co-ordinates both on the Universal Transverse Mercator Grid (in metres) and on the "US War Department Polyconic Projection (Southern Hemisphere) Bank V (South), Zone H" grid (in yards). The latter grid is obsolete but we have included it as it is shown around the edge of the existing plan. We would suggest that any new surveys be carried out on the U.T.M. grid. With these I am including copies of descriptions of stations in Stanley.

Yours sincerely,

C. I. M. O'Brien

C. I. M. O'Brien
Records Officer

The Colonial Secretary,
Stanley,
Falkland Islands.

~~53~~ 12

SPW
SFE

for comments on para 2 ⁴ ~~SPW~~ PL
20.12.62

~~534~~ B

Hon Col Sec.

Map sheets - Stanley and Ex Army Camp.

I have the honour to suggest that if there is a Surveyor available that we get him to survey the run of oil line to be laid in connection with the Oil Storage Tanks south of Power Station.

There are two runs to be considered, the one to Government Jetty and also the Public Jetty, if these surveys could be given on grade it would be a great help in ordering and laying the line.

Another suggestion is that a tracing could be done of the plan of Stanley to be reproduced by F.I.C. machine. The Police Chief is in need of one and P.W.D. need a number to record drainage, water lines and hydrants.

Revisions could be made at the same time by the Surveyor picking up and entering the properties which have been built since the original plan came out.

I can think of no outstanding Colony survey requirements.

S. Pictou.
Supt. of Works.
21st December, 1962.

Hon. Col.

~~535~~ 14

As with Supt. P.W.D. suggestion above.

Guthrie
27.12.62.
15

~~535~~

O.V.C. BACS

B

534

for consideration blank

P 23/12/62

U.C.S.

When a surveyor returns to Stanley
he will be made available.

E. Platt
12.1.63

O.I.C

25

BA-S

I am sorry that
17 — which I have
only just seen has not
been sent to you before.
vide 16.

22/1/63

BU 20.2.63 for achini

no 13517

✓

H.C.S.

One of our surveyors has been engaged on travelling for pipelines from new vents is pretty. He has now left but I will try and get one of the homegoing ones up from round the S. Shuttleton.

E. Duff
2.3.63

27.

O.I.C. BAS

Thank you. Film returned to sender for
on 4/3/63.

28

H.C.S.

I regret that the only Surveyor on the base will not be able to embark and return on the Shuttleton. When the Pioneer arrives in Stanley I will ask him to see the work to be done and see if he can start things which in Stanley.

29

O.I.C. BAS
Notes
on.

30

✓ EG

E. Duff
4.3.63

BU arrived Abasco
5.4.63
20.4.63

ACS - Cordey for
leave deal with him
24/4/63

O.I.C. BAS 32

Accordingly pe. 23.4.63

33

A.C.S.

We have discussed. File
returned for Surgeon's use.

E. Cyl
25-4-63

Record

34

Mr Allan Wright (BRS) called at this
Office this morning & collected a copy of the Plan.
He has only a few days left in Stanley
& will commence making amendments tomorrow.

29.4.63

BU 2. ⁵ 0

NOTES ON THE REVISION OF THE 35

1:2,500 SHEET "PORT STANLEY."

Preliminary checking of the 1:2,500 sheet "Port Stanley" was started on April 19th, 1963, with a view to locating the areas which required additional surveyed detail. There proved to be quite a lot of small corrections necessary covering the area generally rather than isolated cases, and so this preliminary checking was curtailed since it would not have been possible to achieve any worthwhile results in the short time available.

For future reference, it would be best for the complete revision to be undertaken by one person rather than for successive people to undertake parts of it. The time necessary for the job will depend upon the experience of the person undertaking it, but certainly it will be longer than the time usually spent in Stanley by a B.A.S. ship, and so it will be necessary for the person to live in Stanley during the work.

Alan. F. Wright

30/4/63.

ACS.

36

I believe his standards are 1 because we were
so short of copies of his map.

We have now found a lot more 1 than 2.
The Town map is very useful even if it is out
of date. I think the way to look at it is
but if B.A.S. could lend us a surveyor for
a month or two it would be nice to get it
brought up to date but well now, having
discussed the other copies at our camp
we quite well if it can't be brought
up to date. Do you agree?

2/24/63

Am C.S.

37

I agree.

I am not so sure that there is any
great demand for a map showing the exact
position of dwellings etc., although this would
be useful. The main demand is for accurate
positioning of roads for Depts to record routes
of cables, pipes etc carrying power, water
+ drainage.

1.5.63

38

SIC

B.A.S.

Please re 36. I do not know how long a
difference it would be to provide a surveyor to do this
for which I should describe as desirable but
not entirely necessary

2/5/63

Telephone: Derwent 8661.

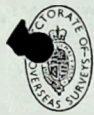

397
DIRECTORATE OF OVERSEAS SURVEYS,
KINGSTON ROAD,
TOLWORTH, SURBITON,
SURREY.

Our Refce.

Your Refce.

504/11

BUF

16th April, 1963.

Dear Sir,

1:2,500 Plan of Stanley

? 17. Under cover of our letter 504/11 dated 3rd November we sent you copies of 1:2,500 sheets "Port Stanley" and "Falkland Camp" graphically revised from the air photographs taken in 1956, for you to check.

We would be most pleased to hear from you when you hope to be able to return these to us for fair drawing and reproduction.

Yours faithfully,

C. I. M. O'Brien

C. I. M. O'Brien
Records Officer.

The Colonial Secretary,
Stanley,
Falkland Islands.

40

We will reply to 29
on subject a reply to 28

K1028

OK BPS

38 fe.

3.5.63

H.C.S.

Re P36 of this file.

B.A.S. could, if requested, bring a Surveyor destined for the Bases next season, out on a earlier ship than that scheduled for him, i.e., Shackleton instead of Kista Dan.

This might, however, necessitate engaging a surveyor, one or possibly two months earlier than necessary for our normal requirements. In this case would Local Government be prepared to re-imburse B.A.S. for such a period. A Surveyor is recruited at a scale of £500 per annum plus £50 to £200 for various degrees.

I think an attempt to get hold of a Surveyor direct from the U.K. would be better than coercing a homeward bound one to stay in Stanley for a length of time.

S. P. H.

42

~~S. P. H.~~ ~~When in the~~

A. G. S. P.

Before S. P. H. left he mentioned that there were several of these maps at the School & promised to let us have some. I wonder if you could investigate the position. If sufficient stocks are held it may not be necessary to proceed with the expensive job of photoenigravated ones.

27.5.63

H. C. S.

43.

Have nine maps which I will deliver to Secretariat

H. C. S.
30/5/63.

44
Y.E.,

This started with our desire to get more copies of the Town Plan.

2. Overseas Surveys suggested that we should first get it revised before getting further copies printed.

now

1. We have found nine more copies of the plan so we are not so short as we thought we were.

2. Mr. Wright the B.A.S. Surveyor who did the preliminary check has reported that the revision will take longer than the normal stay of a B.A.S. ship and thinks it should all be done by one man.

3. We have ideas which may result in the face of the Town being further altered.

3. But I have been thinking of another aspect of this matter. At present I have in my office a copy of the plan which has been coloured by Mr. Oliver and I am extremely grateful to him for this which has been a great help to me in locating lands that have been leased etc. But of course it is not comprehensive and is not up to date. When in doubt I call Mr. Browning who knows most of the land himself. But is this good enough? R.S.C. has plans in his office which show all the land that is covered by Crown Grants. Should not all the different blocks of Crown Land - especially those that are liable to be leased - be properly depicted with the lot numbers. Then the files referring to disposal of each of these lands would be on the lot number and there could be no confusion in future. If a new bit of land was found - e.g. supposing an acre of what had been common was leased to an individual - particulars would be sent to the Directorate of Overseas Surveys who would note the amendment. I am not sure what would be the procedure for amending the copies with us.

4. Above are my ideas but I think if we explained the position the Directorate could advise us. Shall I address them accordingly?

f

45

HCS

I hope a BAS surveyor is

8th July, 1963.

coming out early who cd. help

Ref: 2244

RHDM/TB.

witz this

9.7.63

A.C.S.

I suggest that when the surveyor comes this matter might be discussed with him and Rex. My copy of the plan could be shown to him. He might also be shown the plans in the R.G.'s. office showing the land covered by Crown Grant. It might be advisable simply to have private land coloured and Crown Land white but each bit of Crown Land would have some sort of lot number. This lot number would also be shown on the file dealing with the land. It would be necessary to get all the files dealing with leases since some of the leases are not shown on Mr. Oliver's plan. Furthermore Mr. Oliver's plan is naturally not up to date, for instance 149/44 is still shown as leased. I admit that in many ways it is convenient to have the leases shown in separate colours on the plan but it may be desirable to sacrifice this convenience in the interest of permanent accuracy. However that is a matter which will have to be decided after the surveyor comes.

2. I think that a good deal of the work which would have to be done is drafting rather than actual surveying i.e. a lot of the information which we already have would require to be depicted on the plan without any actual work having to be done in the field.

3. Briefly the object which I am trying to achieve is to ensure that with regard to any bit of land one will by looking at the plan and then if necessary following up by looking at the papers be able to tell what its extent is and what its present disposal is. The final decision as to how this can best be achieved could be made with the advice of the surveyor.

RHDM/LH
10th July, 1963.

47.

Aq RSC

10 sa pl.

15.7.63

48.

How. Lnd. Sec.,

Seen, thank you,

B

Ag. R.S.C.

16.7.63.

49

B. U. mid September for new C.S. to rec.

L.C.

17.7.63

Record

A BAS survey will arrive by "Biscan" in Nov.
re-raise again by Kirk's Dam in Jan. (see fo. 26 of
1905/E

BU 15.9.63

50

17.8.63

BU 15.9.63

There is more for that file. 18.9.63

Telephone: Derwent 8661.

DIRECTORATE OF OVERSEAS SURVEYS,
KINGSTON ROAD,
TOLWORTH, SURBITON,
SURREY



Our Refce.

Your Refce.

504/11

0946/III

22nd August, 1963.

1:2500 Map of Stanley.

1
2
Following correspondence starting with your letter dated 30th August, 1962, we carried out what revision we could from air photographs, see my letter dated 5th October, 1962, but were informed that some development had taken place since the air photos were flown and field completion was therefore necessary.

As you know, we arranged last year for one of the B.A.S. surveyors to spend say three weeks in Stanley on his way home early this year. As it happened there was some misunderstanding in Stanley and the material was not available for him, so nothing was done.

This year we have arranged with B.A.S. for one of their newly recruited surveyors, P. Cotton, to travel out on the first ship, the Shackleton, so that he can do the necessary field work before going further South to Halley Bay. Since there was this misunderstanding last time we are arranging for the material to be duplicated and for Cotton to take it with him. He will also have a theodolite, steel tape and plane table as we understand that B.A.S. have no survey stores in Stanley. I will be grateful if you will reply by signal if these arrangements suit you. Cotton will need accommodation which I suppose you will be able to arrange.

When Cotton has finished his field work, his material will need to be despatched back here and I will be grateful if you will see that this is done, preferably by bag.

yours sincerely,
W.D.C. Wiggins

W.D.C. Wiggins.

R.H.D. Manders, Esq., O.B.E.,
Colonial Secretary,
Stanley, Falkland Islands.

53

Reply at 54

J.E.

Accommodation will be arranged by Rev B.A.S.
Reply to D.O.S. that arrangements are suitable,
please.

L.E.

30. 8. 63

See 62

GOVERNMENT TELEGRAPH SERVICE

FALKLAND ISLANDS

SENT

54

Wt. P2809 5/61

Number	Office of Origin	Words	Handed in at	Date
	Psy			30.9.63.

To
etat DIRECTORATE OF OVERSEAS SURVEYS
KINGSTON ROAD TOLWORTH SURBITON SURREY

52

YRLET 504/11 AUGUST 22 STANLEY MAP STOP ARRANGEMENTS
FINE MANY THANKS

GOVERNOR

Amcs Shackleton's eta is 22.10.63. Should
we seek accommodation at the "Ship" plc? *J* 1.10.63

Time

EPA/ER

eta now 22.10.63 *J*

55
A.C.S.,

O'K BAs answer me that accommodation
will be arranged by him.

L.G.

4.10.63

BW 28.10.63

Place names - Plan of Stanley.

56

- ~~"Falkland Camp" - ^{to be} is titled "Stanley West".~~ ✓
 - ~~"Port Stanley" - "Stanley".~~ ✓
 - ~~"Hospital" ^{to be} is named.~~
 - ~~"Golf course" ^{to be} may be omitted.~~
 - ~~"Govt. Stables"~~
 - ~~"Power House" ^{Station}~~
 - ~~"Schools"~~
 - ~~XXXXXXXXXXXX~~
 - ~~"Gymnasium"~~
 - ~~"Broadcast Studio" ^{it is to be named.}~~
 - ~~"Met. Station"~~
 - ~~XXXXXXXXXXXX~~
 - ~~XXXX "Radio" ^{research} f. s. stat.~~
 - ~~"Winter Station" ^{it is}~~
 - ~~XXXXXXXXXXXX~~
 - ~~"Falkland" ^{to be shown as "Club"}~~ ✓
 - ~~XXXXXXXXXXXX~~ ✓
 - ~~"Stanley Camp" ^{may} be omitted.~~ ✓
 - ~~^{Rubbish} dump to be shown.~~
 - ~~"Slaughter Ho. (F.I.C.) to be omitted." ✓~~
 - ~~"Dockyard" ^{to be} ~~at~~ Govt. Jetty. ✓~~
- certain buildings to be no longer marked solid black, but shaded according to material with which they are constructed.
- Extension sheet to land-mark.

?
C/C. Had we not better send a map

Black buildings to be cross-hatched

57

H.C.S.

Mr Browning has made the comments at 56 with regard to amendments to place names on the new map of Stanley which is being revised at the moment by a R.S.S. Surveyor.

A number of places indicated thus (?) may have to be left ~~blank~~ without titles for security reasons. The remainder of the place names suggested should appear to be in order.

The buildings marked in solid black on the old map are described as Public buildings but for some reason some of the Public buildings have not been shown in this manner. It seems desirable that they should be given their proper titles & shaded according to their construction.

The suggestion to provide a third sheet to include the eastern boundary of Stanley may be useful at some later date, but considering that the Surveyor's time will be limited, this could be shelved.

12.11.63

58

A.C.S.

All buildings etc having a security concern should be left out (names I mean). In all other respects the plan should be brought up to date.

L.G.

18.11.63

BU 28.12.63



59

14

It is requested that, in any reference to this memorandum the above number and date should be quoted.

MEMORANDUM

19th December, 19 63.

To. The Honourable

The Colonial Secretary,

STANLEY.

From. Colonial Treasurer.

Stanley, Falkland Islands.

SUBJECT :-

Board and Lodging for Mr. Cotton, B.A.S. Surveyor.
for November 1963 P.W. voucher 196.

It is understood from the Public Works that the Superintendent has been directed that the cost of board and lodging for Mr. Cotton for November 1963 be charged to the expenditure head for the Oil Storage Tanks Project.

I should be grateful if you would confirm that the correct allocation is XX; 22 Oil Storage Tanks.

[Signature]
Colonial Treasurer.

HTR/CMc.

[Handwritten mark]

On board "Kista Dan", 63
approaching South Georgia.
9/1/64.

Dear Mr. Bound,

I am sorry I was not able to see you before I left Stanley to tidy up matters concerning the work I did on revision of the town plan.

The sheet "Falkland Camp" was not started but "Port Stanley" was nearly completed. I estimate that it will take five or six weeks to finish the work. Allowing adequate time for drawing up the work, one of next season's newly recruited B.A.S. surveyors could usefully occupy his time at Stanley between the first survey vessel of the season and the "Kista Dan". This seems the obvious course to take and I have offered this opinion to Ted Clapp and to Miss McHugo of the Directorate of Overseas Survey, from whom I received my instructions before leaving U.K.

I have asked Ted to return to the Directorate the sheets on which I have made the drawing of my work. Had I had time, I would have made a copy of these to remain in Stanley. The sheets of "Port Stanley" brought for this purpose and the untouched sheets of "Falkland Camp" are at B.A.S. office, together

64
with the surveying & drawing equipment,
awaiting the next surveyor.

I should be grateful if you would
arrange for a list of descriptive names, to be
amended or deleted, to be sent to Miss McHugo
at the Directorate of Overseas Survey, Kingston
Road, Tolworth, Surbiton, Surrey. New names
to be added to the sheets will have to be put
on the maps in the appropriate place by the
surveyor who completes the work.

Perhaps you could include with this
information the answer to the query about
the sheet titles and some comments on
public buildings, which are not so shown, and
buildings incorrectly shown as public. In this
context I should like to raise two apparent
anomalies: the Globe Hotel and a tank at
F.I.C. offices are shown as "public"; only
one of the three churches is shown "public".

I hope that it will prove possible
to have a surveyor complete the work next
season. I shall be interested to see the
final result of our work.

Yours sincerely,
Phil Cotton.

Phil

Colonial Treasurer

Ref. folio 59. You know more about this than I do as you were in the chair at the time. Please direct yourself.

3rd January, 1964

WHT/FH

W1.

61.

The surveyor has accepted largely on the proposed
 pipe line - the allocation is for 8 years.
 Payment authorized accordingly.

L.G.

8.1.64

W1. per.
 10/1/64

62

Ref: 2244.

Colonial Secretary's Office,
Stanley, Falkland Islands.

5th February, 1964.

Dear Sir,

52

I refer to your letter 504/11 of the 22nd August, 1963, and have to inform you that Mr. Cotton has now completed his field work and his material has been posted to you under separate surface cover.

Yours faithfully,

(Sgd.) H.L. Bound

for

COLONIAL SECRETARY

Mr. W.D.C. Wiggins,
Directorate of Overseas Surveys,
Kingston Road,
Tolworth,
Surrey,
SURREY.

Don't forget
the roll

Bu 26/2/64

HLB/IM.

Dec 68

O/C B.A.S.

65

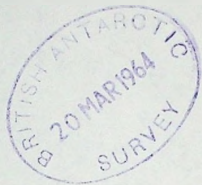

Can Mr Cotton's views regarding the employment of a B.A.S. Surveyor next season be implemented pl?

19.3.64

66

H.C.S.

Arrangements being made.

E. P. H.
22.3.64

67

Seen

W1 ✓

25.3.64

BH 10.6.64



DIRECTORATE OF OVERSEAS SURVEYS

Kingston Road, Tolworth, SURBITON, Surrey

Telephone: Derwent 8661/5

Visiting hours: 9-30 a.m.—4-30 p.m. (Closed Saturdays)

Our reference: 504/11

Your reference:

2244

13th April, 1964.

Dear Thompson,

1:2,500 Map of Stanley

62 I acknowledge with thanks receipt of the material referred to in your letter of 5th February 1964. This comprised the results of Mr. Cotton's field work during 1963 and consisted of three annotated astrafoil sheets and one annotated bromide of the Port Stanley sheet. This had been packed in a cardboard roll and despatched by Parcel Post. The roll was very badly damaged in transit and arrived nearly in two pieces, but fortunately its contents were not damaged. This is valuable original material and I would suggest that next year similar sheets should be returned either by Bag or on one of the B.A.S. ships in the personal charge of one of the officers.

We had earlier received a written report on his work from Mr. Cotton. There is still a certain amount of outstanding work on the Port Stanley sheet and the Falkland camp sheet has yet to be done. This could be tackled next October - December, in a similar fashion by one of the B.A.S. surveyors on his way south if you wish. It means, however, that the revised sheets cannot be published this year.

Mr. Cotton mentioned in his letter that you would be supplying us with a list of names that needed to be added to, deleted from, or amended on the existing map, e.g. street names, building descriptions etc. No list was included in the roll, and we should be grateful to have this as soon as it is complete. It is most helpful if the list is accompanied by a copy of the map marked up to show where the new names are to be inserted. Unless we are told to the contrary we would assume that all the names and descriptions on the existing map are still correct.

Yours sincerely
W.D.C. Wiggins.

W. D. C. Wiggins.

W. H. Thompson, Esq.,
Colonial Secretary,
Stanley,
Falkland Islands.

Copy to: Sir Vivian Fuchs,
British Antarctic Survey,
30, Gillingham Street,
London, S.W.1.

Kiw Bu 10.6.64.

6/10 14.5.64
Si
Repay at 62
Lura

69

Colonial Secretary's Office,
Stanley, Falkland Islands.

Ref: 2244

7th May, 1964.

W. D. C. Wiggins.

Dear Sir,

1:2,500 Map of Stanley

68.

Thank you for your letter 504/11 of the 13th April, 1964. In future we will try and do as you suggest, and I am sorry the sheets were so badly damaged.

I will do my best to get the list of names and amendment out to you on the ship which is due to sail for Montevideo on the 22nd of this month.

18 June

Yours sincerely

(W.H. Thompson) C.S.

W.D.C. Wiggins, Esq.,
Directorate of Overseas Surveys,
Kingston Road,
Tolworth,
SURREY.

WHT/LM

10070

70

3rd June, 1964.

Dear Mr. Wiggins,

68+69
Further to your letter 504/11 of the 13th April, 1964, and my letter 2244 of the 7th May, 1964, I enclose a map marked with the alterations required.

I hope the notes thereon make sense.

The new buildings will, of course, be on Mr. Cotton's new map.

Yours sincerely,

(W.H. THOMPSON)
OFFICER ADMINISTERING THE GOVERNMENT

W.D.C. Wiggins, Esq.,
Directorate of Overseas Surveys,
Kingston Road,
Tolworth,
Surrey,
SURREY.

WHE/IM.

Kiv Bu on
67

Bu 30 11 64

See 74 x 75

74

To Officer Directorate of Overseas
Admission, the Govt, Surveys.
Stanley, KINGSTON ROAD,
Falkland Islands. TOLWORTH,
..... SURBITON, SURREY.

Date... 7 - 8 - 64

RECEIPT IS ACKNOWLEDGED, WITH THANKS, OF

70
your letter 2244
3rd June 1964 and
the enclosed map.

R. Brumby

~~Records Officer~~

Bu 30.11.63 (73)

J.H.

71

BATS Office has very kindly offered us the services of Mr Samuel of Halley Bay on his way out. He could remain in Stanley from about mid February until the last BATS vessel sails in April/May?

15.8.64

ACB

72

Let us say yes: I presume this ties up with the remanance of work referred to in Feb 63.

W1.

73

18.8.64

Discussed with Mr. Clements (BATS) who is advising London Office.

18.8.64

~~Re~~
BW 351164



Our reference : 504/11

Your reference : 2244



DIRECTORATE OF OVERSEAS SURVEYS

Kingston Road, Tolworth,

SURBITON, Surrey,

England.

7th September, 1964.

70
Dear Thompson,

We shall incorporate the annotations marked on the map enclosed with your letter of 3rd June 1964.

In order that the ground revision may be completed this year we have arranged with B.A.S. for one of their newly recruited surveyors - R. Rhys Jones - to travel out on R.R.S. Shackleton so that he may complete the work started by Cotton last year before travelling south to Halley Bay. He will bring with him a copy of the plan incorporating Cotton's revision and he will also bring the necessary survey equipment. Like Cotton he will be very grateful for any assistance that you and the Public Works Department are able to give him and he will also need accommodation. Would you kindly let me know by cable if these arrangements are acceptable to you.

When the survey is completed would you please arrange for the material to be returned to D.O.S. either by bag or in the personal charge of one of the officers on the B.A.S. ships.

yours sincerely

W.D.C. Wiggins

W. D. C. Wiggins.

Reply at 76

W. H. Thompson Esq.,
Colonial Secretary,
Stanley,
Falkland Islands.

Copy to: Sir Vivian
British Antarctic Survey,
30, Gillin Road,
London, S.W. 8.

6/6. 15/1/65

To open cut here
Sender's name and address: W. D. C. Wiggins, O.B.E.,

DIRECTORATE OF OVERSEAS SURVEYS

KINGSTON ROAD, TOLWORTH,

SURBITON, SURREY, ENGLAND

AN AIR LETTER SHOULD NOT CONTAIN ANY
ENCLOSURE; IF IT DOES IT WILL BE SURCHARGED
OR SENT BY ORDINARY MAIL.

← Second fold here →

ON HER MAJESTY'S SERVICE



W. H. Thompson Esq.,

Colonial Secretary,

Stanley,

FAULKLAND ISLANDS.

76

GOVERNMENT TELEGRAPH SERVICE

FALKLAND ISLANDS

SENT

Wt. P2809 5/61

Number	Office of Origin	Words	Handed in at	Date
	Stanley			21.9.64
To				
etat DIRECTORATE OF OVERSEAS SURVEYS KINGSTON ROAD TOLWORTH SURBITON SURREY				HOA/c

75

For Wiggins stop Yourlet 504/11 of 7th September arrangements acceptable
stop Thank you

Thompson

*Riv accommo. (Ship
Hotel?)*

WHT/LH

77

S/c Mr. Clements will accommodate
Sh

*No formal-Ship
Hotel
22.9.64*

22.9.64

S/c.

~~264~~
79

I have arranged accommodation
with Mrs McMillan for the news Surveyor
on his arrival in Kiam from Hallett
Bay.

H. put this note on file.

12.1.65

Ra

wrong file

BU 12.2.65

BU 13.2.65

C.S.

The original intention was for Mr. Samuels to return to UK by either Shackleton or Biscoe.

He is due to arrive in Kildan on Saturday & O'K. BAS has explained that it may not now be possible for them to give him a homeward passage by their vessels & if we are prepared to take the risk, he can disembark on arrival, otherwise he must go on to UK in Kildan.

If Darnin is completely full they (BAS) could almost certainly fix him up with a Campbell to Mont but he would have to fly from there at our expense.

The alternative is to let him go by Kildan & take up the next one on his way out, as we did with Rhys Jones.

18.2.65

80

We have insufficient funds this year to cover air passage: it appears we should take the best one out as with Rhys Jones.

W1. 18.2.65

2244

81

25th February, 65.

To: Officer-in-Charge,

From: The Colonial Secretary,

British Antarctic Survey,

STANLEY.

PLAN OF STANLEY

I refer to our recent conversations regarding Mr. Samuel who, you will recall, had to carry on to the United Kingdom in Kista Dan as we were unable to provide a Government passage. Would you please be good enough to confirm that the incoming Surveyor for Walley Bay next season could be brought out earlier by Shackleton in order that the work commenced by Messrs Cotton and Jones can be completed.

(Sgd) H.L. Bound.

for COLONIAL SECRETARY

HLB/FA

BU 16.3.65
Reply at 82

BRITISH ANTARCTIC SURVEY

82



MEMORANDUM.

Please quote in reply
No. 519/14A

5th March 1965

O.I.C., British Antarctic Survey,
Stanley, Falkland Islands.

The Honourable Colonial Secretary,
Secretariat,
Stanley.

SUBJECT:—

81 Your memo 2244 of 25th February, 1965 refers.

I will pass on to London the views on the necessity of another Surveyor by the first ship next season and will inform you as soon as I receive their reply.

A handwritten signature in dark ink, appearing to read "E. Clapp".

E.C.J. Clapp., O.I.C.,
BRITISH ANTARCTIC SURVEY.

EC/FS

A large, stylized handwritten signature or initials in the bottom left corner of the page.

17th March, 1965.

Dear Wiggins

75

I refer to your letter of the 7th September, 1964.

Rhys Jones did not complete the Stanley survey and his work is preserved here until we get another surveyor (through helpful BAS) to finish it off at the beginning of the southern season.

Unfortunately we have not been able to avail ourselves of the services of a northbound surveyor who was offered to us.

When the survey is completed later in the year the material will be sent on to you.

Yours sincerely,

(W.H. THOMPSON)

W.D.C. Wiggins, Esq.,
Directorate of Overseas Surveys,
Tolworth,
SURREY.

WHT/LS

By 7/4/65
(14 from BAS)

See 86.

BU. 16. 4. 65



DIRECTORATE OF OVERSEAS SURVEYS

Kingston Road, Tolworth,

SURBITON, Surrey,

England.

Our reference: 504/11

Your reference: 2244

30th March, 1965.



Dear Thompson,

Revision of Stanley Town Plan

83 Thank you for your letter of 17th March. It is a pity that the work has not yet been completed.

We were surprised to hear this because we had received a note from Rhys Jones to the effect that he had finished the survey work and plotted his amendments and additions on to his field sheets, but that he had not had time to transfer his work on to the copy to be left in Stanley. If this is so, and the actual field work has in fact been completed we could probably go ahead and draw the maps direct from Rhys Jones' field sheets. This would save another year—but we cannot be sure that it is feasible until his work has been examined.

Armstrong, the second B.A.S. surveyor coming home this year, will be passing through Stanley very shortly. He is a competent surveyor and if you could let him examine Rhys Jones' work and notes he could decide if they were in a form suitable for fair drawing and incorporation into the new maps. If you then were satisfied that the plan was correct as at January 1965, Armstrong could bring the material back in his personal charge. It would not then be necessary to complete the Stanley copy as this was intended as an 'insurance' copy (against loss in the post) and as a guide to anyone continuing the work. If, however, there is still some field work outstanding we must, as you suggest, wait until next season.

Armstrong will of course know nothing of this, and you will need to explain to him what you wish him to do.

yours sincerely

W.D.C. Wiggins

W. D. C. Wiggins.

W. H. Thompson Esq., M.B.E.,
Colonial Secretary,
Stanley,
Falkland Islands

Sender's name and address: W. D. C. Wiggins, O.B.E.,

DIRECTORATE OF OVERSEAS SURVEYS

KINGSTON ROAD, TOLWORTH,

SURBITON, SURREY, ENGLAND

AN AIR LETTER SHOULD NOT CONTAIN ANY
ENCLOSURE; IF IT DOES IT WILL BE SURCHARGED
OR SENT BY ORDINARY MAIL.

Second fold here

ON HER MAJESTY'S SERVICE



W. H. Thompson Esq., M.B.E.,

Colonial Secretary,

Stanley,

FALKLAND ISLANDS.

British Antarctic Survey Offices,

STANLEY,

Falkland Islands.

2nd April, 1965.

Dear Miss McHugo,

The survey and plotting of the Stanley town maps is now completed and I will be bringing the "field sheets" back with me, leaving the "Insurance copies" in the archives at the secretariat. All the field work had already been completed before I arrived by Roderick Rhys Jones (or "Rod the Mod" as he is apparently known locally !) so my work was confined to just plotting up the "insurance copies" and verifying all the names with the assistant colonial secretary, Mr. Morrison. The special astrofoil inks seem to have congealed somewhat and , as I couldn't find a suitable solvent, the plotting on these "Insurance copies" has been done in ordinary waterproof drawing ink and if ever these copies have to be used for photo-copying, they will have to be "gone over" with the special inks. However I think it unlikely that anything should happen to the main copies in transit and so this shouldn't matter. The new names for the two sheets are to be :- "STANLEY" and "STANLEY WEST", replacing "PORT STANLEY" and "FAULKLAND CAMP" respectively. Some detail that has been mapped by Phil or Roderick, such as the radio station, power station and fuel tanks, will have to be erased as it is subject to "S treatment". I have left it plotted for the moment on the copies being returned to you but have erased it on the copies being left here.

The new ²1:50,000 map of East Island has just come on the market here and comments are favourable and the only faults pointed out are in the spelling of place names. Here the faults are

File pl

fairly numerous and before I leave, I'll try to get round to verifying as many as possible and listing corrections in case any future edition is envisaged of the same map sheet. With any luck I'll be able to get out locally and check some of the fences as well (apparently some shown are now non-existent). The survey gear that is at BAS office, I'll pack and send back to D.O.S.

That completes the "shop" side I think and I'll be able to discuss anything else "viva voce" in the near future, at Tolworth.

Yours sincerely

Benny Armstrong

Miss B. McHugo,
Directorate of Overseas Survey,
Kingston Road,
Tolworth, Surbiton,
Surrey,
United Kingdom.

Bu 16/4/65 (83)

fa

BRITISH ANTARCTIC SURVEY

H.C.S.

WITH COMPLIMENTS

STANLEY
FALKLAND ISLANDS

85
B.A.S. Offices,

STANLEY,

Falkland Islands.

22nd April, 1965.

REPORT ON SURVEY WORK CARRIED OUT IN STANLEY AREA

- 1). The revision of the Stanley town plans, now named "Stanley" and "Stanley West", has been completed. B. ARMSTRONG is taking the "field copies" back to U.K. with him on board the R.R.S. "Shackleton" for delivery to the Directorate of Overseas Survey. Insurance copies of the above have been deposited with the Government Secretariat in Stanley in case of mishap to the "field copies". These "Insurance Copies" have not been completely plotted up with the special astrofoil inks (which couldn't be used towards the end as it had congealed) but partly with ordinary waterproof drawing inks and so would require "going over" before copies could be taken photographically.
- 2). Other work carried out ; Following the recent issue of the 1:250,000 sheet of the East Falklands some comments were forthcoming about missing, etc. and so an effort was made to find out as many errors as possible for rectification in any future edition of the map. These are also being returned to U.K. with B. ARMSTRONG.

A local survey was carried out on ~~the~~ the government land in the Stanley area to verify the existence and positions of fences and boundaries. This was for the use of the local Agricultural Dept. who retain a copy of this work. The field sheet has been retained for further correction of the local maps by D.O.S.

(B. ARMSTRONG)

Surveyor with the B.A.S.

PAA

8th May, 1965.

Revision of Stanley Town Plan

86

~~At~~ thank you for your letter reference 504/11 of the 30th of March.

As you know Armstrong, the second B.A.S. surveyor, has completed the work left by Rhys Jones.

I hope all will now be well.

(W. H. THOMPSON)

DATA

W. D. C. Wiggins, Esq.,
Directorate of Overseas Surveys,
Tolworth,
Surrey,
SURREY.

TB

C.S.

About a year ago B.A.S. Surveyor Armstrong completed the survey of Stanley on which work had earlier been done by Surveyors Cotton and Rhys-Jones.

2. Could you please let me know what stage has been reached as regards publication of the result and whether any additional expenditure will be incurred?

CW

16 / 3 / 66

Acc do you know ?

S.

S/C we used to receive progress reports on this.

16/3 Can you refer me to?

7244

File

C.S. Pl. see fos. 40/41 of

946/A attached

18.3.66

S.

C946 attached

2502

21/3

17.3.66

PA. ✓