

R/NAT/GEN/FH4

NATURAL HISTORY – GEOGRAPHY

HUNTING AEROSURVEYS LIMITED.

Topographical and cadastral survey of the Falkland Islands.

Twenty numbered aerial photographs of the Falkland Islands taken  
October to November 1956.

*For further information see files NAT/GEO/1#14, 1#17, 2#1 and 2#3*

Part of the FIC COLLECTION but filed with Natural History.

Telephone: Derwent 8661

DIRECTORATE OF OVERSEAS SURVEYS,

KINGSTON ROAD,

TOLWORTH, SURBITON,

SURREY.

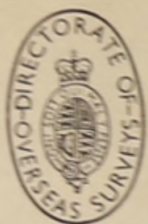

Our Refce.

Your Refce.

504/11

13th October, 1959

(Visiting hours  
9.30 a.m.-4.30 p.m.  
Closed Saturdays.)

Dear Mr. Young,

... Further to our telephone conversation on 8th October I enclose an index diagram to both the future 1:50,000 maps of the Falkland Islands (in black) and to the existing air-photo mosaics or print laydowns (P.L.D.'s) at 1:100,000.

The Print Laydowns are marked in red, the red numbers being the appropriate reference; all are available from this Directorate at 12s 6d per copy. Should you wish to order any, please would you direct the request to the Records Officer at the above address.

Yours faithfully,

*Petra Searle*

(Mrs. P. Searle)  
Map Officer, (P.I.D.S.)

Mr. Young,  
Falkland Islands Co.  
120, Pall Mall,  
LONDON. S.W.1.

*Miss L. C. Hugo*

*original prints 4/6 each 9" x 9"*

P.L.D.'s ARE MARKED IN RED  
THE FALKLAND ISLANDS  
15' x 30' Sheets

CO.  
Sh. 1  
SCALE  
SECTION  
D.O.S. N  
PLATE  
DEMAN

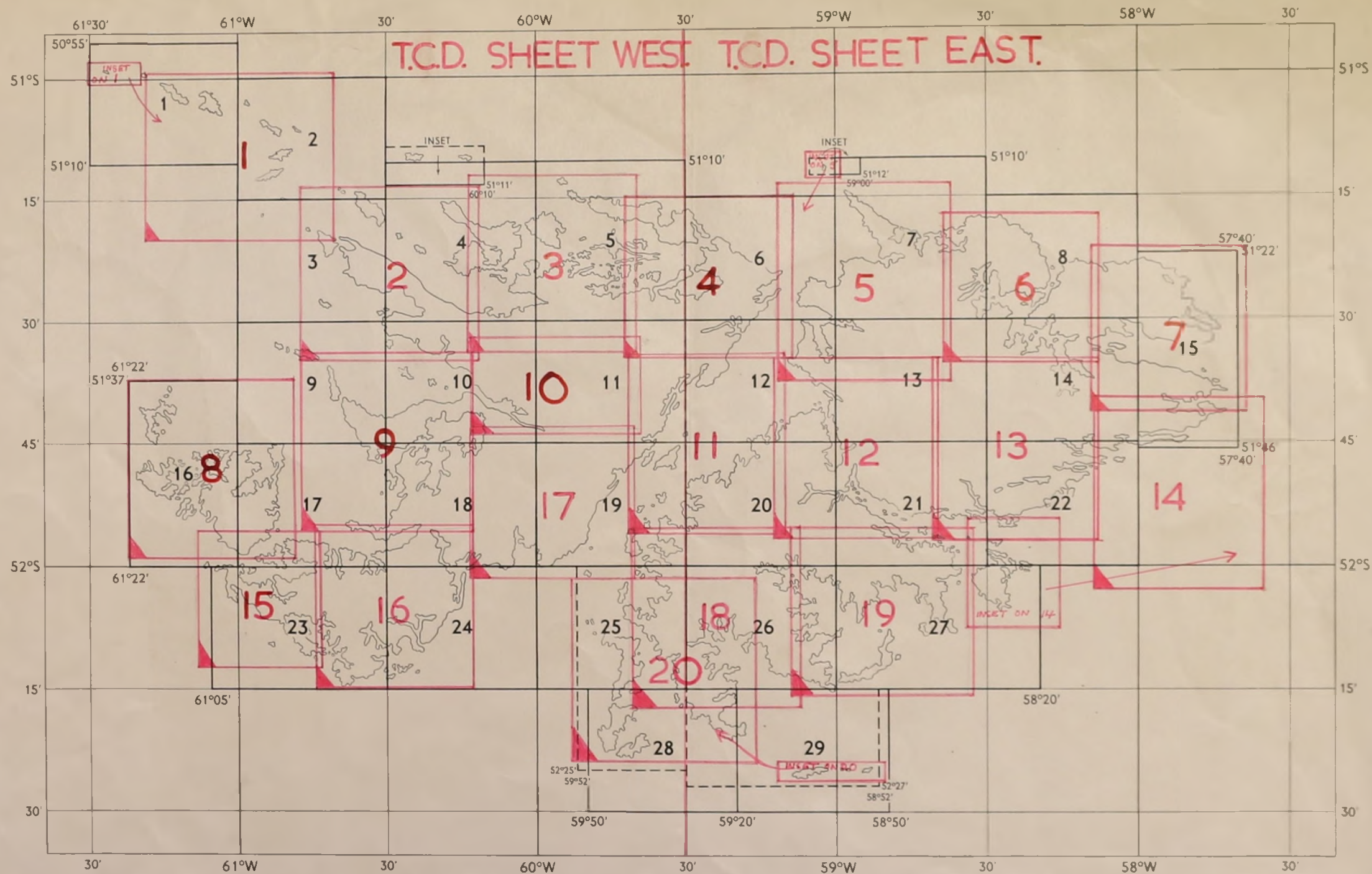

## FALKLAND ISLANDS

SHEET 1

PRINT LAYDOWN



DOI: 10.1002/for  
 © 2004 Blackwell Publishing Ltd

APPROXIMATE SCALE

Prepared by Directorate of Overseas Surveys from photography  
by Hunting Aerials Ltd. Oct. - Nov. 1956.

6707/4/85

PRINT LAYDOWN

# FALKLAND ISLANDS

SHEET 2



801/11/12  
© Crown Copyright Reserved

APPROXIMATE SCALE

0 1 2 3 4 5 6 7 8 9 10 Miles

Prepared by the Directorate of Overseas Surveys from photography  
by the British Overseas Survey Ltd. (1985)



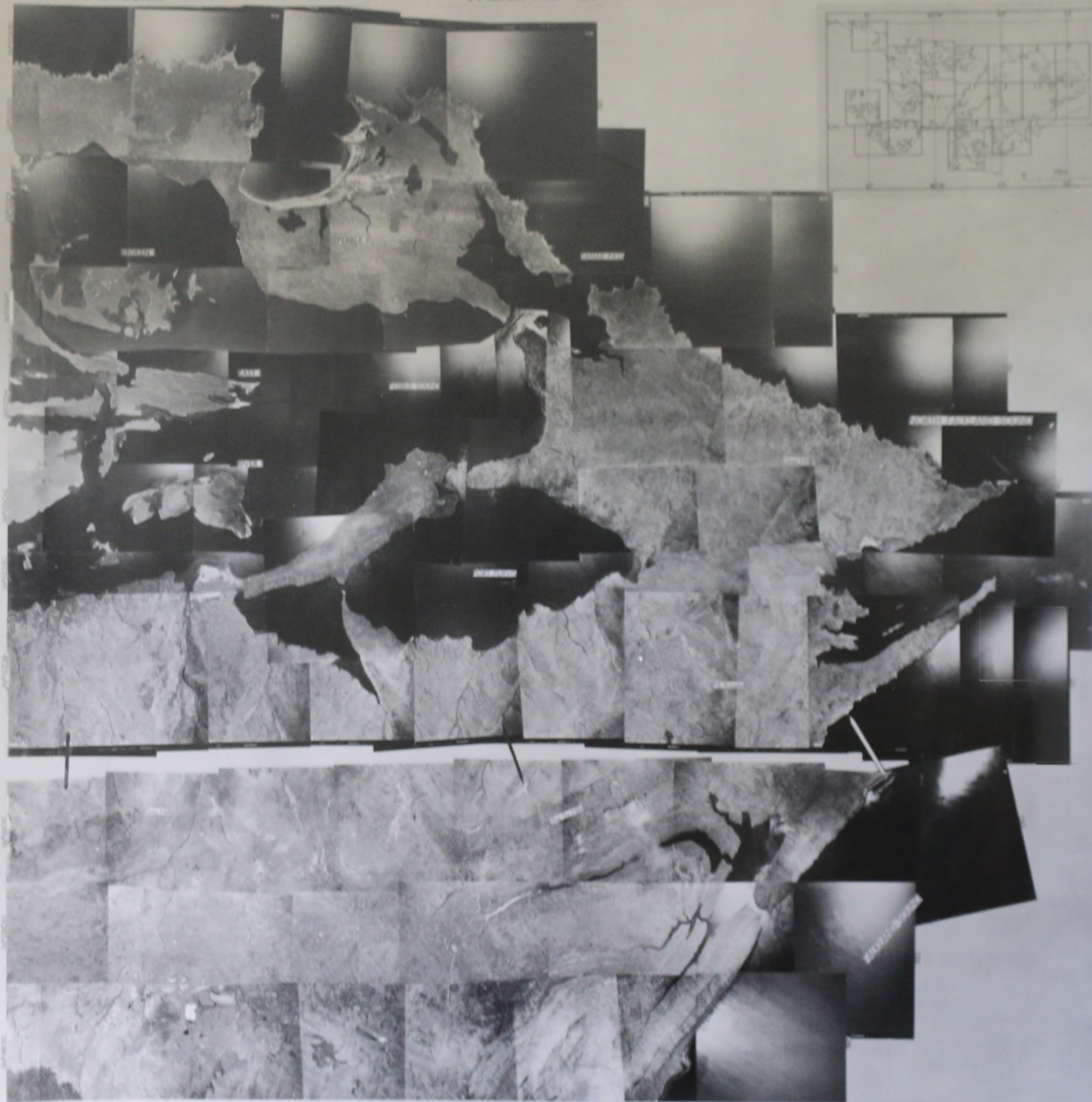
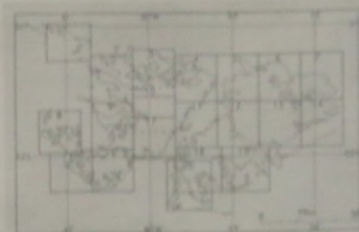

DOA/PLT/13

LONDON COPYRIGHT RESERVED

APPROXIMATE SCALE

0 1 2 3 4 5 6 7 8 9 10 Miles

Prepared by Directorate of Charting Services from photography  
by Thomas Robertson Ltd. Ltd. Nov. 1966.



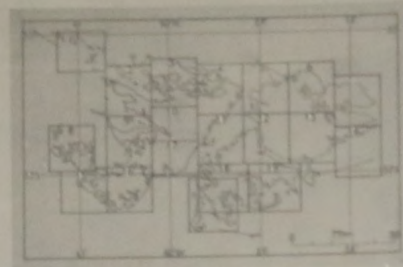

D.O.S. P.L. 116  
CROWN COPYRIGHT RESERVED

APPROXIMATE SCALE

0 1 2 3 4 5 6 7 8 9 10 MILES

Prepared by Directorate of Overseas Surveys from photography  
by Hunting Aerosurveys Ltd. Oct/Nov. 1956

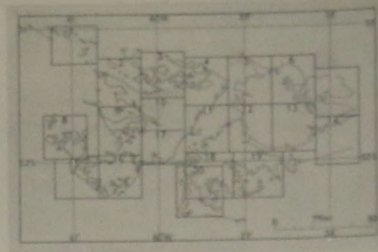

BERKELEY SOUND

Copyright  
All Rights Reserved

APPROXIMATE SCALE  
0 1 2 3 4 5 6 7 8 9 10 Miles

Prepared by Directorate of Overseas Surveys from photography  
by Hunting Aerosurveys Ltd., Oct./Nov. 1956.

# FALKLAND ISLANDS

SHEET 8

PRINT LAYDOWN

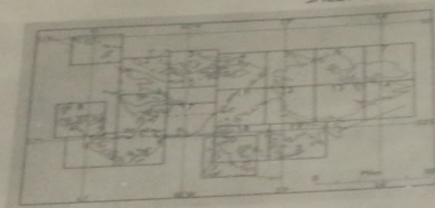

APPROXIMATE SCALE

0 1 2 3 4 5 6 7 8 9 10 Miles

Prepared by Directorate of Overseas Surveys from photography  
by Hunting Aerosurveys Ltd. Oct. - Nov. 1956.

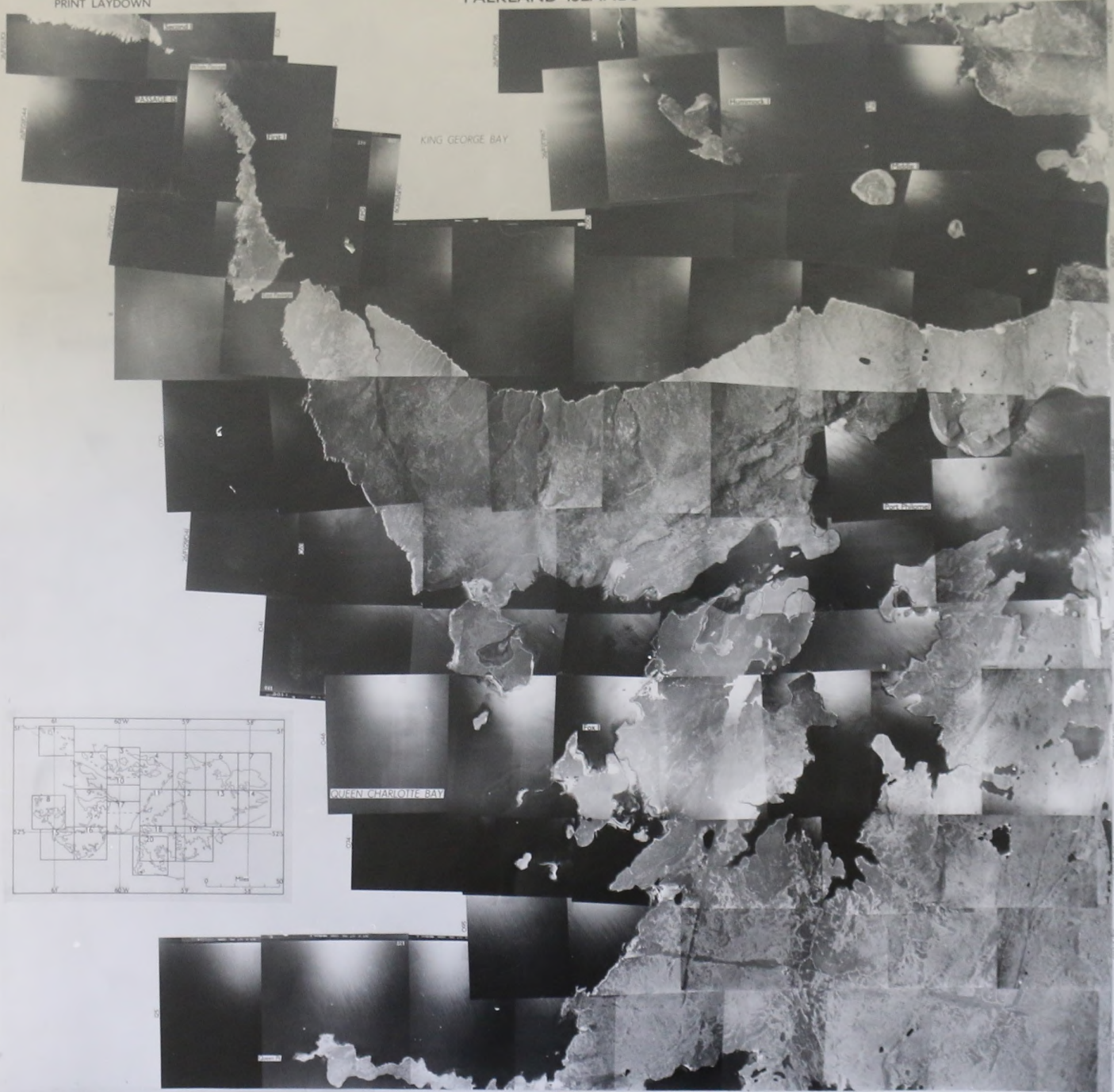



D.O.S. (P.L. F.I. 10)  
CROWN COPYRIGHT RESERVED

APPROXIMATE SCALE

0 1 2 3 4 5 6 7 8 9 10 Miles

Prepared by Directorate of Overseas Surveys from photography  
by Hunting Aerosurveys Ltd. Ltd. Nov. 1956

PRINT LAYDOWN

# FALKLAND ISLANDS

SHEET 11



DOX PL 1111  
CROWN COPYRIGHT RESERVED

APPROXIMATE SCALE

0 1 2 3 4 5 6 7 8 9

10 1966

Prepared by Directorate of Overseas Surveys from photography  
by Hunting Aerosurveys Ltd., Oct. Nov. 1966





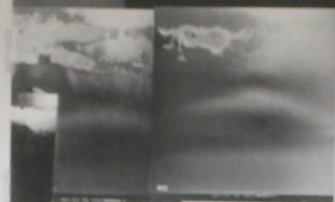

LOC. OF ISLANDS

APPROXIMATE SCALE

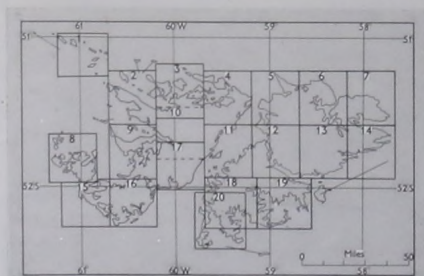

ALL RIGHTS RESERVED

APPROXIMATE SCALE

0 1 2 3 4 5 6 7 8 9 10 Miles

Prepared by Directorate of Overseas Surveys from photography  
by Hunting Aerosurveys Ltd., Oct.-Nov. 1956.

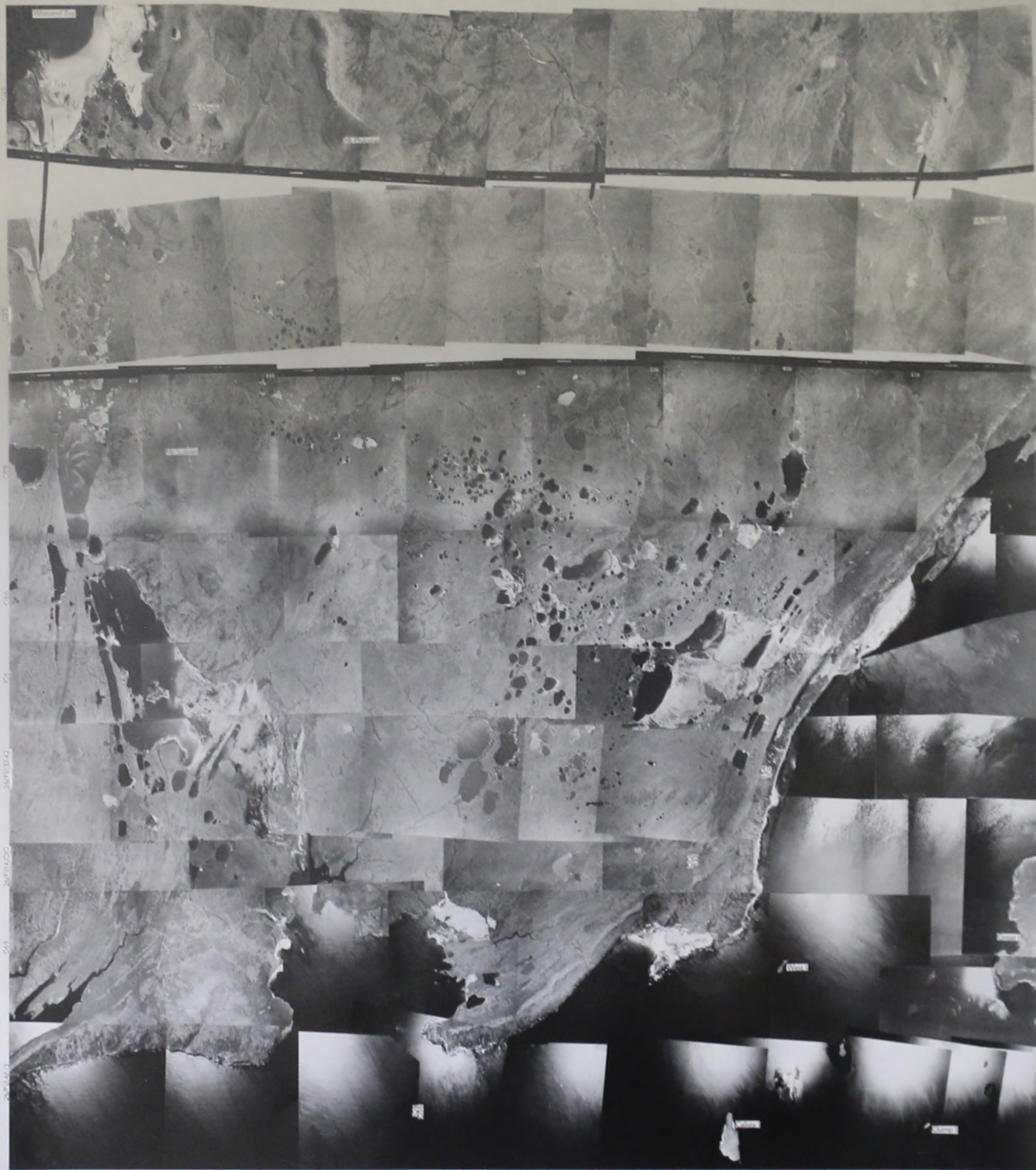

D.O. PALFUT  
DOWN COPYRIGHT RESERVED

APPROXIMATE SCALE

0 1 2 3 4 5 6 7 8 9 10 Miles

Prepared by Directorate of Overseas Surveys from photography  
by Hunting Aerosurveys Ltd. Oct. Nov. 1956

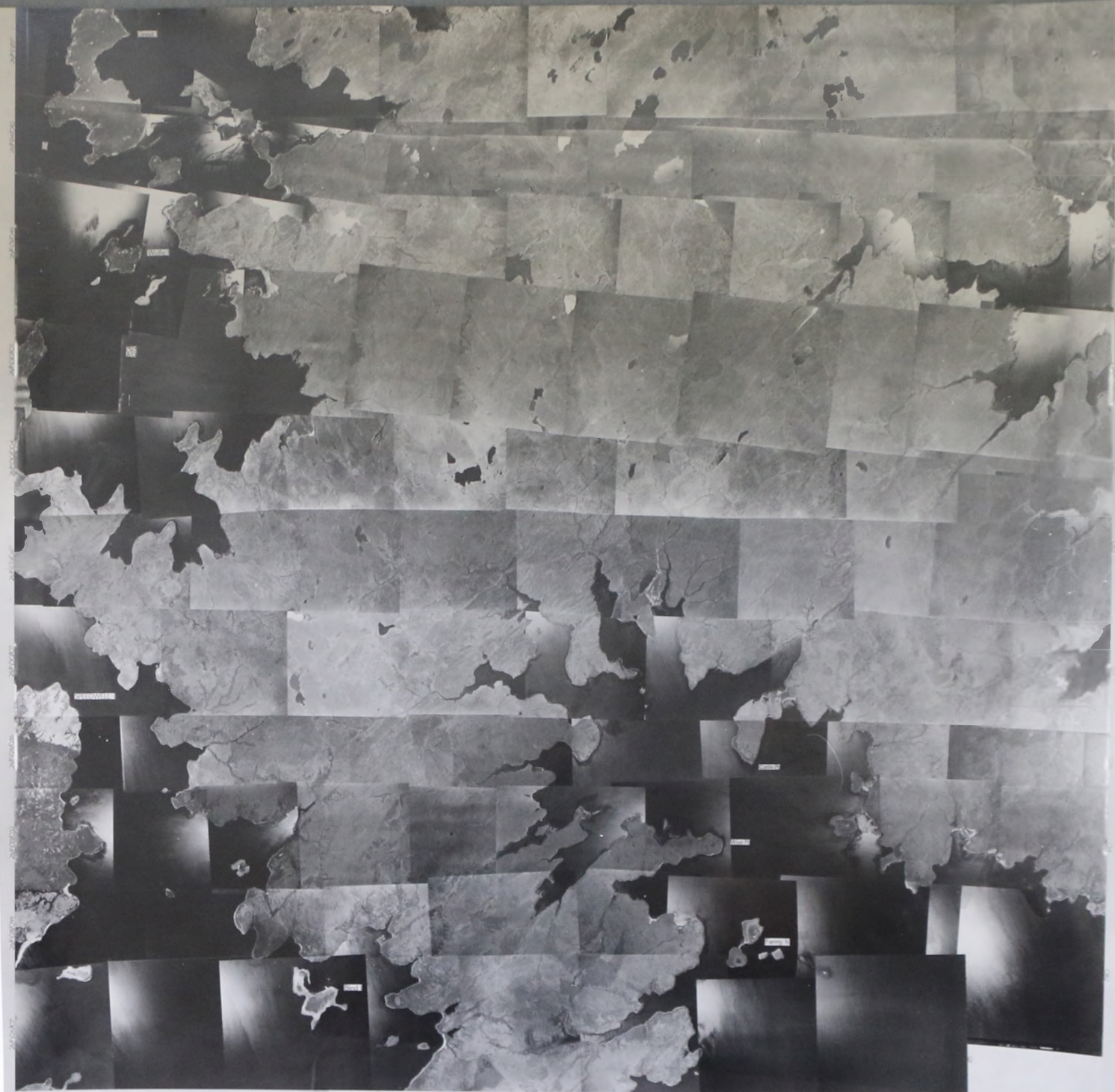
C.S. P. 1118  
CROWN COPYRIGHT RESERVED

APPROXIMATE SCALE

0 1 2 3 4 5 6 7 8 9 10 Miles

Prepared by Directorate of Overseas Surveys from photography  
by Hunting Aerial Surveys Ltd. Oct. Nov. 1956.



DOS PL 1119  
 Crown Copyright Reserved

APPROXIMATE SCALE

0 1 2 3 4 5 6 7 8 9 10 Miles

Prepared by Directorate of Overseas Surveys from photography  
 by Hunting Aerosurveys Ltd. Ltd. Nov. 1956



APPROXIMATE SCALE

Prepared by Directorate of Overseas Surveys from photography  
by Training Squadron 100, USAF, Nov. 1956